

**gemini**  
ITALY

PORTABLE RECHARGEABLE  
USB BOTTLE JUICER BLENDER

隨身USB充電式果汁攪拌機

Model No./型號: GRB350V

Before using your product for first time, please read this instruction manual.

在使用本產品前，請仔細閱讀本說明書并保存好。

# SAFETY INSTRUCTION

**Attention!** When using electric tools, basic safety precautions should be followed to reduce the risk of fire, electric shock and personal injury, including the following:

Read all these instructions before operating this product and keep these instructions for future reference.

1. Read and save these instruction.
2. Check the voltage indicated on the rating plate. This juicer is designed for DC 5V/2A electric supply.
3. Cleaning and user maintenance shall not be made by children without supervision.
4. The appliance is only to be used with the power supply : 5V/ 2A provided with the appliance.
5. Incorrect operation and improper handling can lead to faults on the appliance and injuries to the user
6. In the event of improper use or incorrect handling, no liability can be accepted for any damage that may occur.
7. Do not operate the appliance if the mains cable or the mains plug show signs of damage, if the appliance has fallen on the floor or has been otherwise damaged. In such cases take the appliance to a specialist for checking and repair if necessary.
8. Never remove the mains adapter & USB outlet from the socket by pulling on the mains cable, or with wet hands.
9. Ensure that the mains cable does not hang over sharp edges or allow it to become trapped.
- 10.Keep the appliance away from damp, and protect from splashes.
- 11.Keep the appliance and its cord out of reach of children less than 8 years.
- 12.Use the appliance on a flat, dry and heat resistance surface.
- 13.Do not operate the juicer in an area where gasoline painting or such flammable liquids is used or stocked.
- 14.Do not let hand or other objects put into the bottle when operation the juicer. They could be hurt your finger / hand to causing damage or injuries.
- 15.Do not use this juicer in a damp area such as bathroom.
- 16.Do not use this juicer near a window.
- 17.Use this juicer only as it is describe in this manual.
- 18.Do not try to disassemble this juicer and fix it by user, If you need maintenance, please send back the juicer to our After-sales Service Center.
- 19.All components of this juicer must not be replaced by the user.
- 20.Turns on the machine without fruits / liquid will stop in 5 seconds , the longest juicer time per cycle is 30 seconds, will stops automatic , the spot flashing. Please reset the switch before switching on. Do not continuously squeeze juice to avoid the electronic original load too large and hot, affecting the life of the product.
- 21.When the juicer battery consumption is insufficient, plug in the charging cable with the adapter / current of more than 5V / 2A (this accessory is not supplied), and use the attached USB charging cable for charging. After full charging , the juicer will working and can be used.
- 22.The longer the battery is used or placed, the shorter the battery discharge time.
- 23.During normal use, the motor is locked when the pulp is too large to cause it to stop. The line protection program is turned on and the indicator will flashing and automatically disconnected. After the switch is disconnected, the indicator will stop flashing and double-click the On / Off Button to run again.
- 24.Do not put any parts of this product into various cleaning equipment such as dish washing machine.
- 25.Do not use steel ball, abrasive detergent or saprophyte liquid to clean this product.
- 26.This juicer, should not twist meat, grinding other strong fruit(Such as : Nuts, Chinese medicine, coffee bean ).
- 27.When the juicer is working, it is strictly forbidden to open the upper cover and put the hands or other hard objects into the bottle to prevent accidents.
- 28.To make baby food,you can put cooked fruits,vegetables,beans and other ingredients into bottle,then add water or milk,and release to make nutritious rice paste and other supplementary food.

## WARNING



- This appliance can be used by children aged from 8 years and above and persons with reduced physical, sensory or mental capabilities or lack of experience and knowledge if they have been given supervision or instruction concerning use of the appliance in a safe way and understand the hazards involved.
- Children shall not play with the appliance. Cleaning and user maintenance shall not be made by children without supervised.
- There are no serviceable parts in this unit. Do not attempt to disassemble.
- Never use this juicer with any solid-state speed control device. Doing so will create fire and/or shock hazards.
- Not allow children/Baby to put finger inside the juicer bottles or stirrer to avoid injury/danger.

## APPLIANCE COMPONENTS

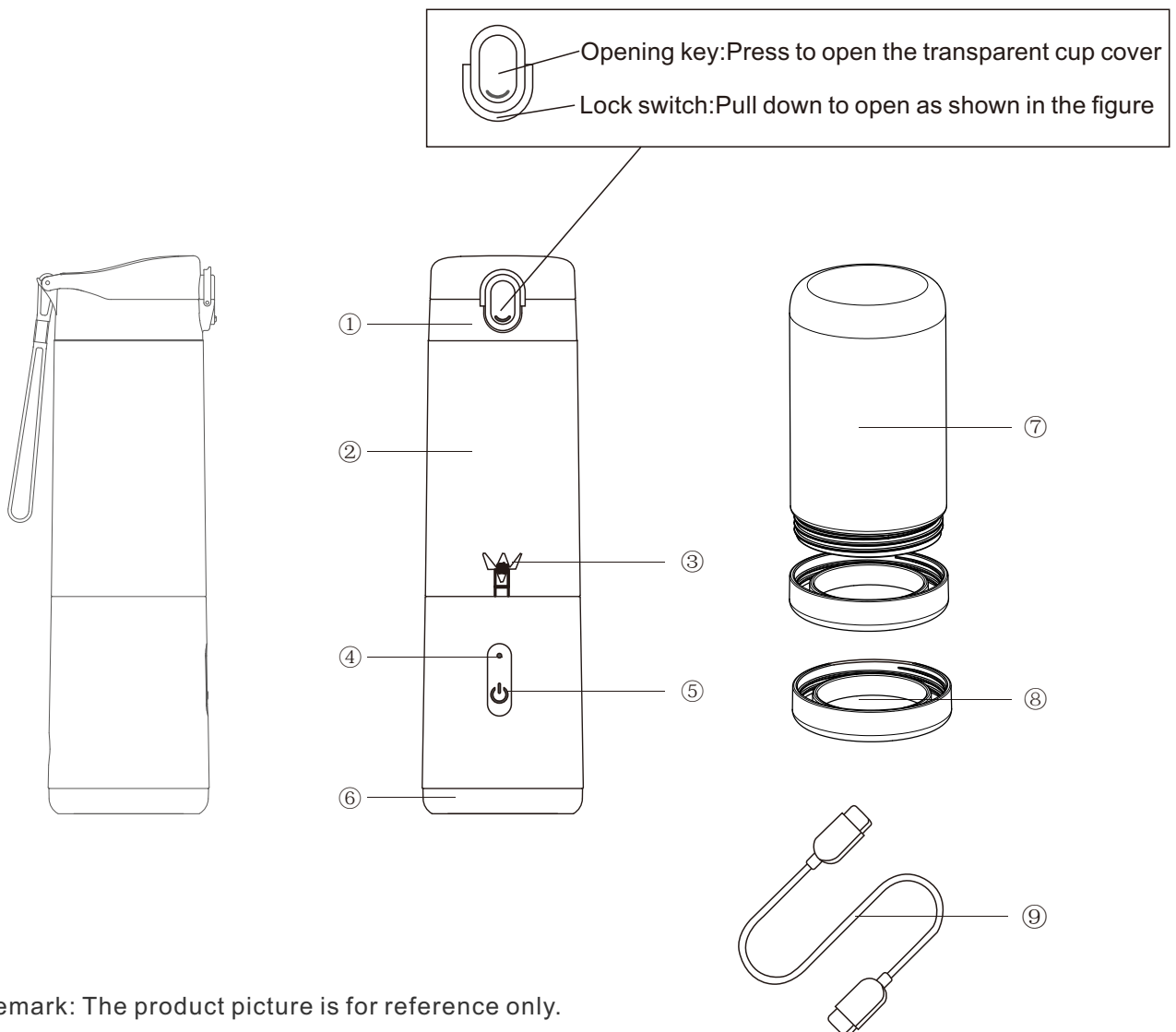
- ① Transparent cover with straw for plastic bottle ② Plastic bottle ③ Cutting blades ④ Indicator  
⑤ On/Off button ⑥ Base ⑦ Glass bottle ⑧ Bottle base cover ( Plastic & Glass ) X 2 pcs  
⑨ USB charging cable ( not include power plug )



Remark: The product picture is for reference only.

Model	GRB350V
 On / Off Button	Double-click the On / Off Button to start operation for up to 30 seconds. The indicator turns to blue during operation. Continuous juicing will cause excessive heating of electronic components and affect the service life of the machine. It is recommended to operation every time for rest about 1 minute.
 Indicator	Standby mode, the indicator shows blue flashing, the indicator turns to blue during operation. Full charging indicator shows blue color. If the red indicator light is flashing , it means the protection alert is ON and the machine cannot be operated, it needs to twist the bottle tightly to the base as standby mode. The red and blue indicator lights flash alternately to indicate the blade is blocked by the fruit/food alert signal, open the bottle and clear the blocked fruit/food on the cutting blade, then the alert signal can be released . If the red light is always ON, it means insufficient voltage need to recharge the unit.
 Micro USB port	USB charging port, insert the end of USB port to the port of base, then connect the USB pin to the suitable power plug ( DC 5V/2A this part is excluded) for charging
Power Supply	DC5V(The power adapter is not included in package)
Input (Micro)	2A
Charging Time	About 3 hours under no battery use condition (with DC5V - 2A) (power adapter not include this part in package)
Charging Indicator	Indicator light will be red
	Indicator lights will be blue
Weight	812g(including Plastic & Glass bottle and lid)
Product Dimensions	73 W*260 H*80 D mm (With plastic bottle)
Battery capacity	2400mAh Li-battery
Motor speed	14000 rpm

## HOW TO USE

User must install the bottle and transparent cover lid to the plastic bottle before assemble with unit. The bottle install and twist tightly on the unit base to avoid water leakage during operation. Before use of the juicer, make sure that the battery is fully charged and clean both bottles and lid with the ingredients.



The product has dual safety protection switch :

- I : Juicer only will work after the bottle is fixed on the seat tightly.
- II. Juicer only will work with double-click the On / Off Button to start operation

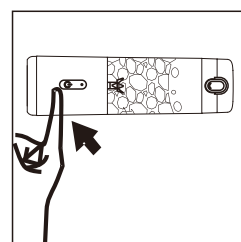
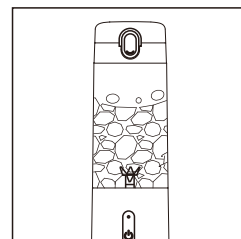
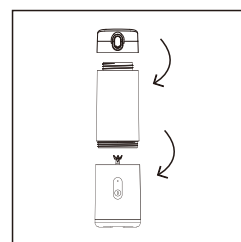
1. Wash the fruit and cut it into about 1.5x1.5cm cubes. A fruit with a core, hard material, thick-skinned or hard shell, please remove it first.
2. Add the topped fruit, only about 40% of the bottle . After adding the water, the total quantity is about 80% ( 300 ml ) of the cup capacity
3. Tighten the transparent cover with straw for plastic bottle, and lock the lock switch upward. When the bottle is screwed into the base, see the blue light flickering, and then screw it until the hand can not rotate. Make sure that the bottle and silica rim are sealed.
4. Use it for horizontal position as image, Double-click the On/Off button  to operate. The fruit for apple , pear , citrus, etc. will blend for about 30 seconds. Shake the product lightly at work, the juice effect is better.



5. After the juice is done, turn off the power switch and turn on the transparent bottle cover lid with straw to drink instantly. If there is more fruit dregs, please use filter before drinking.

6. Double-click the On / Off button  to start working.  
Click the On/Off button  once to Off.

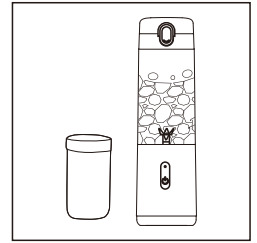

7. For smoothies, place ice cubes in the bottle (ice cubes must be less than 1.5\*1.5cm cubes). Do not exceed the half position of the cup, and then add the right amount of water or milk, cover the cup lid, inverted boot. Make sure the smoothie is filled with liquid and turn the glass upside down at the start to prevent the ice from getting stuck in the blade.



### Warning!

1. It's strictly forbidden to remove the cup and turn it on!
2. Do not remove the bottle cover or bottle from the base while operating. It will cause danger.

### Warning!

1. Do not immerse the juicer base into water when cleaning!
2. When cleaning cutting blades, emptying juicer bottle and cleaning the cutting blades carefully to avoid causing danger. Do not press/touch the On/Off button while cleaning the product and ensure the silicon USB charging port cover is closed.
3. Read all these instructions before operating this product and keep these instructions for future reference.

## NOTE

1. When the battery is exhausted, the juicer will automatically turn off to protect the equipment.
2. The battery is not detachable. Please do not squeeze or remove the battery. This may lead to environmental pollution or even explosion.
3. When the ambient temperature exceeds 50°C / 140°F, it is strictly prohibited to use the fan.
4. Before seasonal storage, please charge the battery to 75% at least and suggest to charge the battery once in every 2 months in order to prolong the service life.
5. If the juicer stops working in long time, please keep charging the battery fully charged.
6. If you put the product in a wet place, its life will be shortened.
7. For your safety, please do not put your fingers or any foreign matters into the cutting blades, juicer cup or USB charging port.
8. Bottle capacity is 300ml, and the maximum capacity is recommended not to exceed 300ml when releasing food materials.
9. When the machine is working, do not open the bottle lid to add ingredients or extend your hand into the cup.
10. May get dyeing on the silicone rim for discolouring fruits. Pay attention and do not touch the blades when bottle is detached.
11. Open the silicone cover with care to avoid damage.
12. Do not splash or rinse water on silicone cover/USB port at the back.

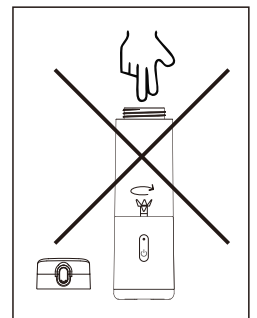

## WHAT'S IN THE BOX

- Juicer base with blades \*1
- Bottles ( Plastic & Glass ) \*2
- Bottle cover lid \*2
- Transparent cover with straw for plastic bottle \*1
- USB charging cable \*1
- User manual \*1

## HOW TO CLEAN

1. Must be turn off the Juicer before cleaning. Do not press / touch with the On / Off button. Close the USB port cover tightly before cleaning.
2. After use every time, please clean in time, do not immerse the juicer base into water when cleaning , the power supply must be cut off first. After clean the whole product, wipe clean with a dry cloth.
3. All parts should not be cleaned with hot water up to 60°C or prohibited to place in a high-temperature sterilizer. Use warm water with a proper amount of detergent Wash with a brush and rinse under tap water.

Remove and clean with the following steps:

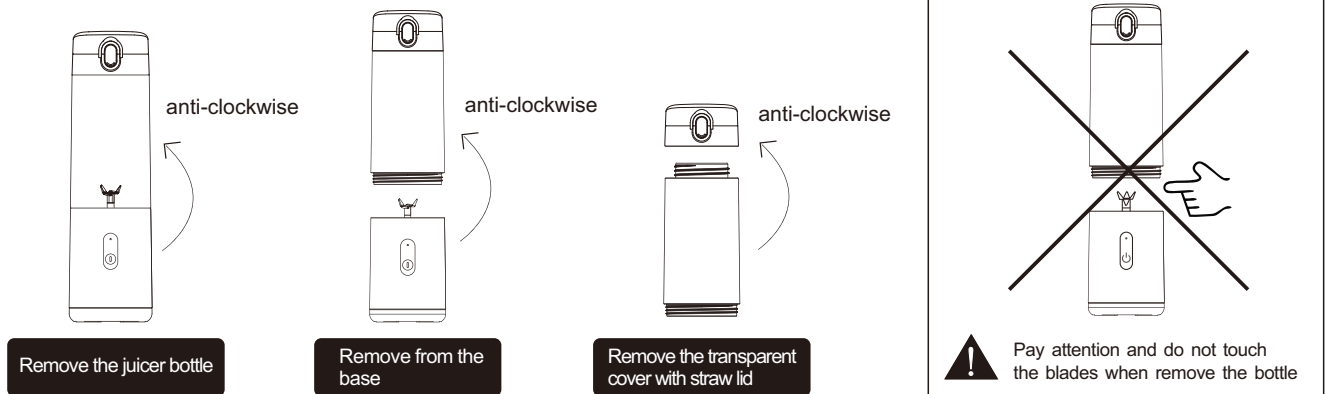

## MULTIPLE CIRCUIT PROTECTION

- **Over-charge protection:** When voltage reaches 3.7V, it will automatically stop charging and prevents the damage caused by the over charging of the battery.
- **Over-discharge protection:** when the battery is depleted. This product will automatically stop .
- **Over-voltage protection:** When the external charging voltage is higher than 4.2V, it will automatically stop charging.



This marking indicates that this product should not be disposed with other household wastes.

To prevent possible harm to the environment or human health from uncontrolled waste disposal, recycle it responsibly to promote the sustainable reuse of material resources. To return your used device, please use the return and collection systems or contact the retailer where the product was purchased. They can take this product for environmental safe recycling.

## PRODUCT SPECIFICATION

**Model:** GRB350V

**Working Voltage:** DC5V/2A

**Power:** 30W

**Battery capacity:** 2400mAh Li-battery

**Maximum capacity:** 300ml each for both plastic and glass bottle

**Product size:** 73 W\*260 H\*80 D mm ( With plastic bottle )

**\*The final product specification may be varied according to a different lot of material and actual input voltage power If the usage area.**

## 重要安全事項

注意：

當使用此產品時，應遵循基本的安全預防措施，以減少火災、觸電和人身傷害的風險，包括以下內容：  
在使用本產品之前，請閱讀所有使用說明，並將其保存，以備將來參考。

1. 閱讀並保存此說明書。
2. 檢查銘牌上標示的電壓。本榨汁機適用於直流5V / 2A電源。
3. 兒童不得在無人監督的情況下進行清潔和維護。
4. 本產品使用5V / 2A的直流電源供電，USB充電線隨機配送。
5. 不正確的操作和不恰當的操作可能會導致設備故障和用戶受傷。
6. 如果使用不當或操作不當，任何可能發生的損害概不負責。
7. 如電線或插線位有損壞痕跡，則不要操作本產品。在這種情況下，如有必要，可將本產品交給專業人員進行檢查和維修。
8. 切勿拉扯電線或用濕手將電源插頭從USB插座上拔下。
9. 確保電源線不懸掛在有鋒利邊緣的地方。
10. 防止本產品受潮，本產品主機不能被放入水中。
11. 不要讓8歲以下的兒童接觸到設備及電源線。
12. 該產品請在平坦、乾燥和耐熱的表面使用。
13. 不要在有汽油、油漆或易燃液體的地方使用。
14. 操作榨汁機時，不要將手或其他物體放入攪拌杯中靠近攪拌刀。有可能造成損傷或受傷。
15. 不要在浴室等潮濕地方使用該產品。
16. 不要在靠近窗戶的地方使用該產品。
17. 請按此手冊使用該產品。
18. 切勿自行拆卸及修理，如需維修，請將本榨汁機送回本公司售後服務中心。
19. 該產品所有部件不能由用戶更換。
20. 本產品無水果或液體時開機空轉5秒會停止，每次最長榨汁時間為30秒，空轉5秒或者工作30秒後自動停止，藍燈閃爍。重新工作請將開關鍵連續按兩下即可。請勿連續強度榨果汁，以免電子元件負荷太大並發熱，影響產品壽命。
21. 當榨汁機電池電量不足時，插入輸出電壓 / 電流為5V / 2A的充電插頭（不供應此配件），並使用附送USB充電線進行充電，充滿電後可以使用。
22. 電池的使用時間與使用壽命，使用時間越長或放置的時間越久，電池放電時間會縮短。
23. 在正常使用時，當食材過大卡住刀片或食材過於濃稠時，馬達會被鎖定，電路保護程序自動開啓，指示燈閃爍。開關斷開以後指示燈停止閃爍，再連續按兩下開關鍵，可以重新運行。
24. 請勿將本產品任何部件放入洗碗機等各種清洗設備中清洗。
25. 請勿使用鋼絲球、研磨性清潔劑或腐蝕性液體來清潔本產品。
26. 本產品為專業鮮果榨汁機，不宜絞肉、研磨其他堅果（如堅果、中藥、咖啡豆）。
27. 榨汁機工作時，嚴禁擰開上蓋，將手或其他硬物放入杯體，以防發生意外。
28. 製作嬰兒食物時，可以將煮熟的瓜果、蔬菜、豆類等食材放入杯中，再加入水或牛奶，攪打製作成營養米糊等適合嬰幼兒食用的食物。

## 警告

- 本產品適用於8歲及以上的兒童。身體、感觀、智力低下或缺乏常識和經驗的人，需要有成人監督或指導說明安全使用方法，了解可能的危險後，方可以使用本機。
- 不可讓兒童把玩本產品，兒童不得在無人監督的情況下進行清潔和維護。
- 沒有專用工具，不要試圖自行拆卸本產品。
- 切勿將本榨汁機與任何調速裝置一起使用，這樣做會造成火災或電擊危險。
- 不允許兒童或嬰兒將手指放入榨汁機或攪拌器內，以避免傷害或危險。

## 產品部件

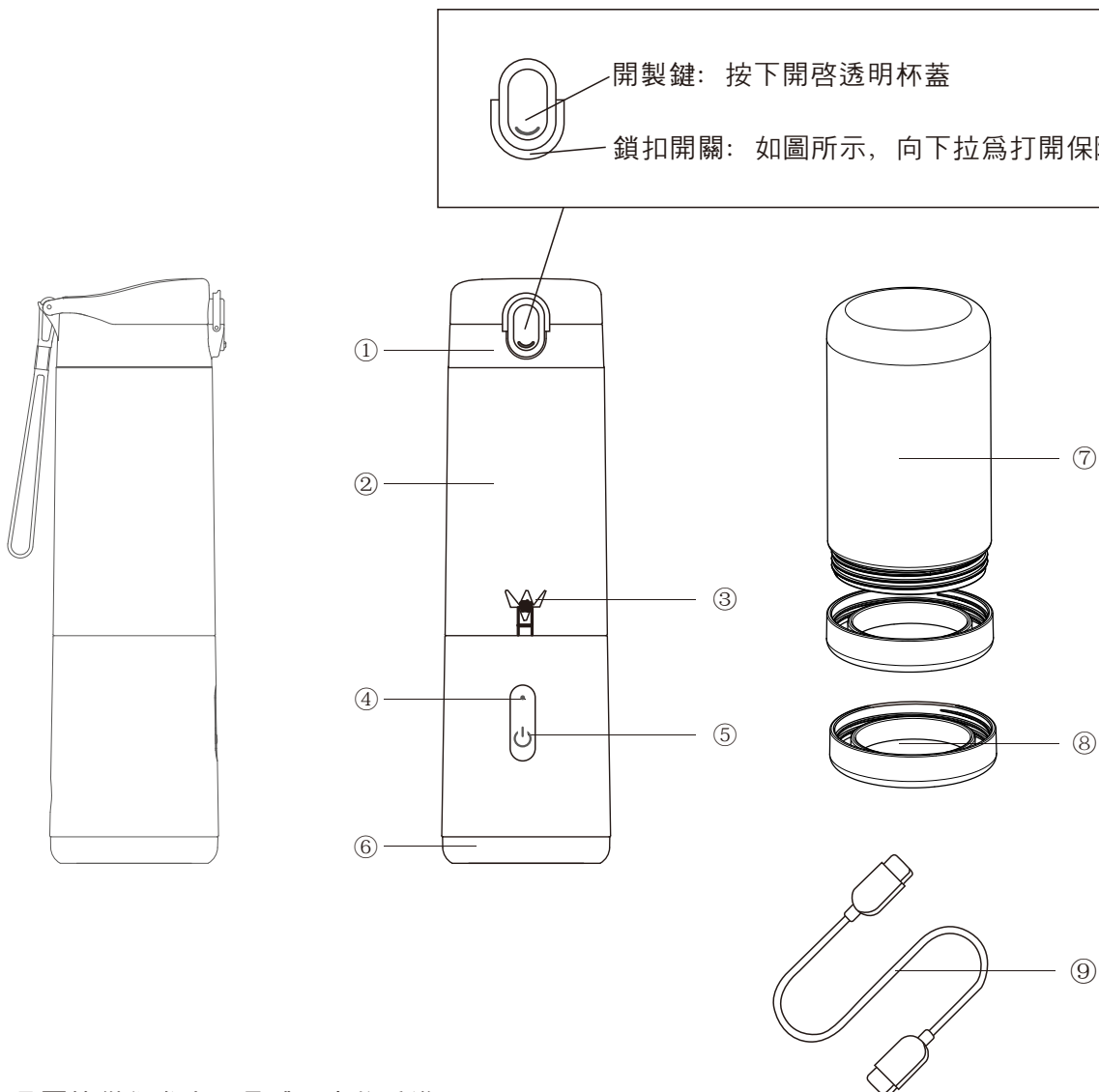

部件說明：

- ①帶吸管透明杯蓋 ②塑膠杯 ③攪拌刀 ④指示燈 ⑤開關按鍵  
⑥底座 ⑦玻璃杯 ⑧杯底蓋\*2個 ⑨USB充電線（不含電源插頭）



備注：產品圖片僅供參考，具體以實物為準。



型號	GRB350V
 開關鍵	連續按兩下開／關按鍵,榨汁機啓動,再按一下關閉,榨汁時間爲30秒。工作時藍燈常亮。連續榨汁會導致電子原件發熱過大,影響機器使用壽命。建議每次運行間隔1分鐘左右。
○ 指示燈	當安裝杯子上主機時,若紅燈閃爍表示杯未裝好或空轉保護,必須把杯子擰緊在主機上,然後藍燈閃爍表示進入待機狀態下可以工作,運行時指示燈變爲藍色常亮。插入USB充電時紅燈常亮,充滿電後指示燈爲藍色常亮,指示燈紅、藍閃爍表示刀片被卡住的提示,打開杯子清除刀片上被卡住的食材後可以解除提示。如果紅燈一直亮著,則表示電壓不足,需要給本機充電。
 USB充電口	USB充電端口,將USB端口的一端插入底座端口,然後將USB連接到合適的電源插頭(DC5V / 2A)進行充電。
輸入電壓	直流5伏(本產品不包含電源適配器)
輸入電流	2安培
充電時間	無電量情況下約3小時(DC5V-不包括2A電源適配器)
充電指示	充電時指示燈顯示紅色,完成充電後顯示藍色
產品淨重	812克
產品尺寸	長73*高260*深80毫米(連塑膠杯)
電池容量	2400毫安培時鋰電池
轉速	14000 / 分鐘

## 使用方法

請務必按照指導安裝杯子和透明杯蓋。  
在初次使用產品前,請確保電池充滿狀態後再使用,並徹底清洗與食材接觸的部件。

本產品設有雙重安全保護開關:

- I. 杯體完全擰緊於機座上,指示燈爲藍色閃爍,表示待機可以工作。
- II. 安裝正確後,連續按兩下開關鍵,榨汁機工作,此時藍燈常亮。

1. 將水果洗淨,切成約1.5\*1.5厘米小方塊  
(有核、厚皮或硬殼的水果,請先將其去除)。
2. 放入水果,約占杯體的40%,再加入水或牛奶後,使總量約占杯體容量的80%(300毫升)。
3. 擰緊杯蓋,按下透明蓋,並向上鎖住開關鎖扣。杯子擰入機座時,看到藍色燈閃爍後,再擰緊至手擰不動爲止。確保杯身與矽膠蓋密封不漏水。
4. 將榨汁機橫置,連續按兩下開關啓動機器,馬達轉動後再正置。蘋果、梨、柑桔等水果榨汁時間均爲30秒。工作時輕輕搖晃產品,榨汁效果更好。

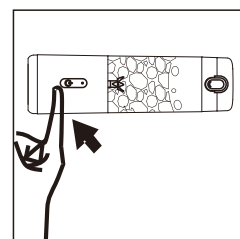
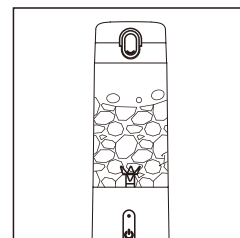
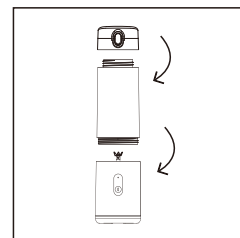

5. 榨汁完畢後，關閉電源開關，打開杯蓋即可用飲用。  
如果果渣較多請先用過濾網過濾後再飲用。

6. 開關功能，連續按兩下開關鍵 $\text{\textcircled{I}}$ 啓動機器：再按一下開關鍵 $\text{\textcircled{I}}$ ，即可停止工作。

7. 打沙冰，可以將冰塊放入杯中（冰塊一定要少於1.5\*1.5厘米小方塊），不超過杯子一半位置，再加入適量的水或牛奶，蓋上杯蓋，倒置開機即可。注意打沙冰時一定要加液體，並且啓動時注意將杯子倒置，防止冰塊卡住刀片，待刀片轉動起來後再將杯子倒回來。

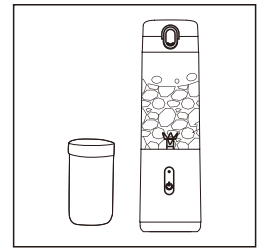

#### 警告!

1. 嚴禁將杯體拆掉後開機!
2. 攪拌機進行時嚴禁把杯蓋擰開移取走或把杯體移離本機，以免發生意外!

#### 警告!

1. 清洗時不要將榨汁機底座浸入水中!
2. 擰開榨汁機杯身，清洗榨汁機刀片時要小心，以免造成危險。  
清洗時注意不要按到開/關按鈕，並確保矽膠USB充電口蓋處於關閉狀態。  
使用本產品前請閱讀本說明書，並妥善保管，以備將來參考。

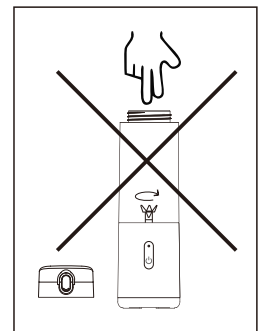

## 注意事項

1. 當電源耗盡時，榨汁機會自動關閉，以保護設備。
2. 電池是不可拆卸的，請勿擠壓或拆卸電池。這可能會導致環境污染甚至爆炸。
3. 當環境溫度超過50° C / 140° F時，嚴禁使用榨汁機。
4. 在季節性存儲前，請至少將電池充電至75%，並建議每2個月充電一次，以延長電池使用壽命。
5. 如果榨汁機長時間停止工作，請保持電池充滿電。
6. 如果你把產品放在潮濕的地方，它的壽命會縮短。
7. 爲了您的安全，請不要將手指或任何異物放入刀片、攪拌杯內或USB充電口。
8. 瓶身最大容量爲350毫升，建議放入食材攪打時不參超過300毫升。
9. 當機器工作時，不要打開瓶蓋添加配料或將手伸入杯中。
10. 帶色水果可能會導致矽膠圈變色。拆卸杯子時，注意不要碰到刀片。
11. 請勿過度用力打開矽膠蓋以免損壞。
12. 切勿用水沖洗或濺在機背的矽膠蓋 / USB充電口。

## 產品內容

- |                 |    |
|-----------------|----|
| 1. 帶刀片的榨汁機底座    | 1個 |
| 2. 杯子（塑膠和玻璃各一個） | 2個 |
| 3. 杯底蓋          | 2個 |
| 4. 透明塑膠杯蓋       | 1個 |
| 5. USB充電線       | 1條 |
| 6. 用戶手冊         | 1本 |

## 清洗方法

1. 使用後請及時清洗，主機部分嚴禁直接浸入水中或用水沖洗；擦拭主機時，必須先斷電源，然後用乾布擦拭乾淨；除主機部分外，其它部分均可放入水中沖洗。
2. 可拆卸部分不能用高於60℃的熱水清洗，也不能放在高溫的消毒櫃中，可用溫水加適量清潔劑用刷清洗，然後用水沖洗即可。
3. 參照以下步驟拆卸清洗即可：

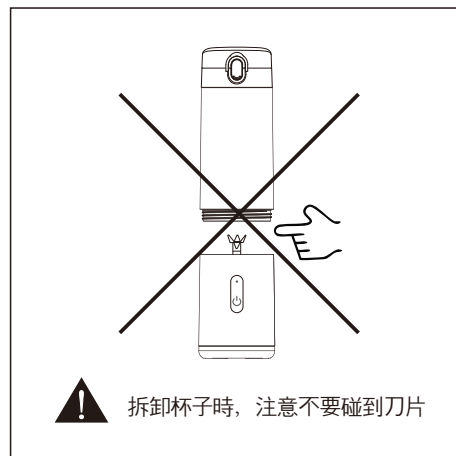
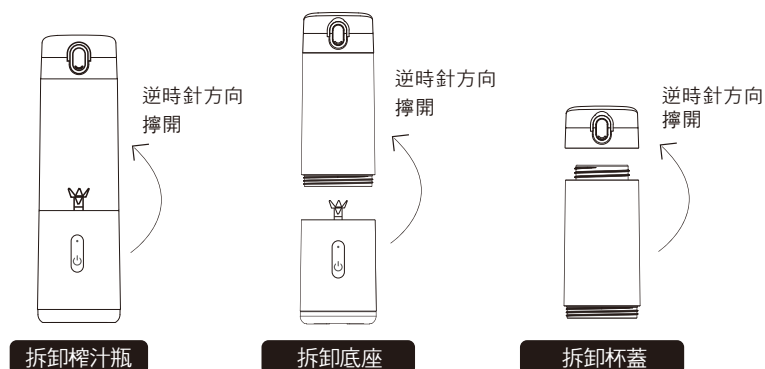

## 多重電路保護

- 過壓保護：當單節電池電壓高於3.7V，會自動停止充電，防止電池過充造成的損壞。
- 過放保護：當電池電量耗盡時，榨汁機不會啟動，以保護電池。
- 過充保護：充電時當電池電壓達到4.2V時，自動停止充電。



此標記表明，本產品不應與其他家庭廢物一起處置。為防止不受控制的廢物處置可能對環境或人類健康造成損害，對其進行負責任的回收，以促進物資資源的可持續再利用。若要退回您的舊設備，請使用返回和收集系統，或聯系採購此產品的零售商。他們可以把這種產品用于環境安全回收。

## 產品規格

- 產品型號：GRB350V
- 工作電壓：DC5V/2A
- 使用功率：30瓦
- 電池容量：2400mAh鋰電池
- 最大容量：塑膠瓶和玻璃瓶各300毫升
- 產品尺寸：長73\*高260\*深80毫米（連膠杯尺寸）

\* 相關產品的規格，可能會因配件批次或實際使用地區的電壓差異而有所不同

請記錄下列產品資料

● 型號

---

● 機身編號

---

● 經銷商名稱

---

● 購買日期

---

本產品不斷改進中，如功能有所更改，恕不另行通知，如有疑問，請與客戶服務中心聯絡，不便之處，敬請原諒。

說明書內容以英文版本為準

## **ToolBox Customer Service Centre 客戶服務中心：**

4/F, DCH Building, 20 Kai Cheung Road, Kowloon Bay, Hong Kong  
香港九龍灣啟祥道20號大昌行集團大廈4樓

Customer Service Hotline 客戶服務熱線：(852) 8210 8210

Service E-mail 電郵地址：8210service@gilman-group.com

Please register now at 請即上網登記：www.toolbox.hk

Website 網址：www.gilman-group.com



Proudly Serviced by:



a Gilman Group Company

# **太平家庭電器**