



gemini
ITALY

**10-IN-1 MULTI-
FUNCTIONAL COOKER**
10合1多功能煮食鍋

MODEL NO/型號.: GMC15V
1500W



A GILMAN GROUP BRAND

Please read and retain for future reference.

SAFETY INTRUCTIONS – GENERAL

- Please read these instruction carefully and retain them for future reference.
- Use this appliance solely in accordance with these instructions.
- This appliance is for household use only, not for commercial purpose.
- Remove all packaging material from the appliance before use.
- This appliance shall not be used by children of 0 to 8-year old.
- This appliance can be used by children older than 8-year old and persons with reduced physical, sensory or mental capabilities or lack of experience and knowledge, but only if they have been given supervision or instruction concerning use of the appliance in safe way and understand the hazards involved.
- Children should be supervised to ensure that they do not play with the appliance.
- Cleaning and maintenance must not be done by children.
- Keep the appliance and the cable out of reach of children under 8-year old.
- Have any repairs carried out solely by a qualified electrician. Never try to repair the appliance yourself.

SAFETY INTRUCTIONS – ELECTRICITY AND HEAT

- Verify that the mains voltage is the same as that indicated on the rating plate on the appliance before use.
- Make sure that you always use a grounded wall socket to connect the appliance.
- Always remove the plug from the wall socket when the appliance is not in use.
- Remove the plug from the wall socket by pulling the plug, not the power cord.
- Make sure that the appliance, the power cord and plug do not make contact with water.
- Make sure that the appliance, the power cord and plug do not make contact with hot surface, such as a hot hob or naked flame.
- Check the appliance's power cord regularly to make sure it is not damaged. Do not use the appliance if the power cord is damaged. If the power cord is damaged, it must be replaced by an electrical technician or a person with similar qualification, in order to avoid any hazards.
- When using an extension lead always make sure that the entire cable is unwound from the reel.

- Use solely approved extension leads.
- The appliance needs space to allow heat to escape, thereby preventing the risk of fire. Make sure that the appliance has sufficient space around it, and does not come in contact with flammable material. The appliance, the air vents must not be covered or blocked when use.
- Never use the appliance in the vicinity of flammable material.
- Certain parts of the appliance may get hot. Do not touch these parts to prevent scalding yourself.

Warning: Do not touch the hot surfaces of the glass lid and the inner metal pot when the appliance is in use.

Warning: Slight smoke on the first use is a normal occurrence. It will disappear shortly afterwards.

Warning: Due to the thermal expansion and contraction of the heating tube in the inner pot, it may have a “Bipa” sounds during the use of the appliance, It is safety and a normal occurrence. Please be assured use.

SAFETY INTRUCTIONS – DURING OPERATION

- Never use the appliance outdoor.
- Never use the appliance in damp rooms.
- Make sure your hands are dry before touching the appliance, power cord or plug.
- Place the appliance on a flat, stable surface where is cannot fall.
- Never allow the power cord to hang over the edge or the counter, worktop or table.
- Do not pick up the appliance if it falls into water. Remove the plug from the socket immediately. Do not use the appliance again.
- Never immerse the appliance, the power cord or the plug in water or any liquid.
- Clean the appliance thoroughly after use (Please refer to “Cleaning and Maintenance” section).
- This appliance may not be used through an external timer or by means of a remote control.

PRODUCT OVERVIEW

- 1.Handle of glass lid
- 2.Glass lid
- 3.Inner metal pot
- 4.Handle of unit
- 5.Base tray
- 6.Control panel
- 7.LED display



Accessories

Warning: All accessories are not dishwasher safe

1. Frying basket x 1pc



Assembly of basket by fold up the handle in position

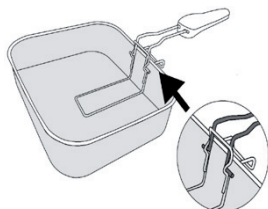

After frying, mount the Frying Basket by its hanger hook on the Inner Metal Pot to drain away the extra oil.

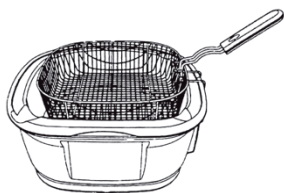

2. Steam rack x 1pc

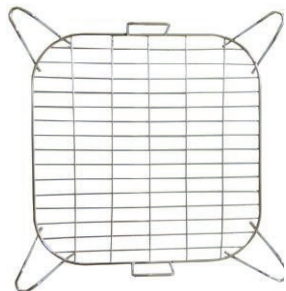

Place the steam rack on the 4 supporting slots of the Inner Metal Pot when steam cooking.

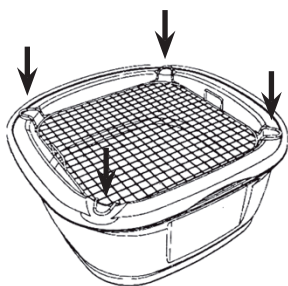

3. Grill rack x 1pc

Place the grill rack on the Inner Metal Pot when using grill function.

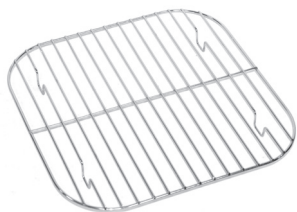

Control panel

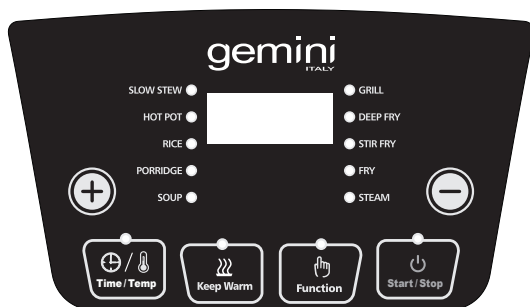

ASSEMBLY INSTRUCTION

1. Assembly the handle on the glass lid.

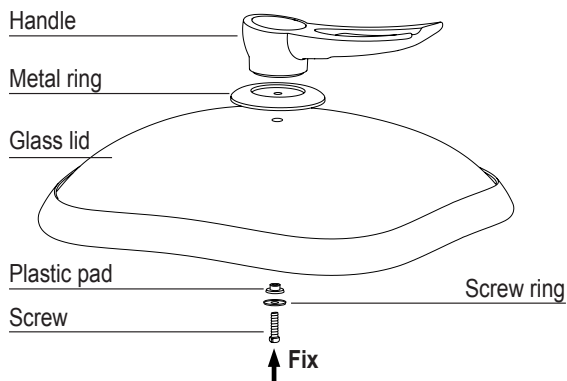

2. Assembly the Inner metal pot

- Please remove the foam under the inner metal pot before first use.
- Make sure the appliance is power off while assemble the inner pot.
- **Remove:** hold the handle, then pull upwards. (Please make sure the inner pot is cooling down enough.
- **Fix:** make sure the connector is fixed into the hole for base plate, then push the inner pot tightly.
- Finish the assembly, the appliance is ready to use.

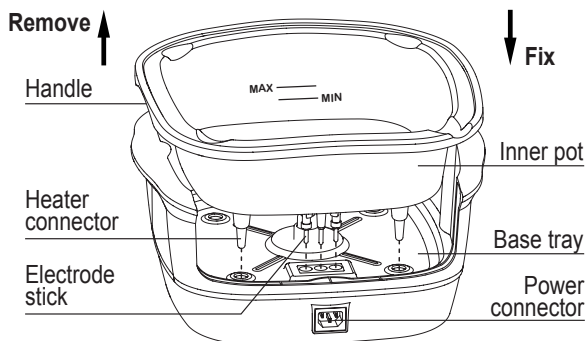

USAGE INSTRUCTIONS

- Connect the appliance to the power source. A “beep” sound is heard. The LED display will be on and shows ----- which is at standby mode now.
- Press the “Function” button to choose between the different cooking programs.
- No food and water can be exceed the maximum line inside the inner metal pot (Max.).
- Food and water should be at leaset reach the minimum line inside the inner metal pot (Min.)

Such as in Slow Stew, Hot Pot, Rice, Porridge, Soup, Deep Fry and Steam

- After a cooking program is selected, you may also adjust the time and/or temperature (if needed). The time and temperature range between different cooking program are as below -

Cooking Program	Default Program		Adjustable Setting	
	Cooking time (Hr:Min)	Temperature	Cooking Time (Hr:Min)	Temperature
Slow Stew	06:00	100°C	0:01-5:59	Non-adjustable
Hot Pot	02:00	240°C	0:01-1:59	120-240°C
Rice	00:35	150°C	Non-adjustable	
Porridge	01:00	110°C	0:01-1:30	100-140°C
Soup	01:00	110°C	0:30-2:00	Non-adjustable
Grill	00:30	240°C	0:01-9:59	180-240°C
Deep Fry	00:30	180°C	0:01-9:59	180-240°C
Stir Fry	00:15	240°C	0:01-0:30	50-240°C
Fry	00:25	200°C	0:01-0:59	50-240°C
Steam	00:15	220°C	0:01-1:59	100-220°C

- Press “Time/ Temp” button to swap the time and temperature setting:
 - 1.To adjust the Time (if needed) – press the “Time/ Temp ” button 1 time on the control panel after selecting program, LED display will be blinking, then press “+” or “-“ button to adjust the time needed.
 - 2.To adjust the Temperature (if needed) –press the “Time/ Temp ” button 1 time on the control panel after selecting program, LED display will show the unit of “C”, then press “+” or “-“ button to adjust the temperature needed.
- When a cooking time and cooking temperature are set, please press the “Start / Stop” button once to begin the cooking process.
- If the “Start / Stop” button is pressed during the cooking process, the appliance will go into stand-by mode and the selected cooking program will be cancelled.

Keep Warm Function

- When the appliance is in standby mode, pressing “Keep Warm” button to activate the keep warm function.
- The keep warm indicator will be ON and the display is shown “bb”. The keep warm function will keep warm for the appliance at approx. 60°C - 80°C at the first 6 hours.
- To cancel the Keep Warm setting, please press the “Keep Warm button” again to disable the Keep Warm feature.
- When the selected cooking program is completed, it will switch to keep warm function automatically, and then switch to the standby mode automatically after 2 hours.

Cook with difference cooking program

- The appliance pre-set 10 cooking programs. Press the “Function” button to choose between these cooking programs in a cycle: Slow Stew, Hot Pot, Rice, Porridge, Soup, Grill, Deep Fry, Stir Fry, Fry and Steam.
- The corresponding indicator will be blinking while selecting the cooking program.
- Time and Temperature may need to adjust according to your setting
- Press “Start / Stop” button once to activate the selected cooking program. The corresponding indicator of the program will be lit.
- Once the cooking program is selected and started, no other program can be selected until finish the current program. But the time and temperature can be adjusted anytime.
- The red indicator will light on once you selected the cooking program.
- The cooking program can be stopped by pressing the “Start/ Stop” button in any time during cooking. The selected program will be cancelled.
- You may also adjust the cooking program in stand-by mode. After adjusted the cooking program, press the “Start / Stop” button again to re-start the cooking program.
- There is a “beep” tone to indicate the program completed and it will switch to keep warm function automatically. After 2 hours, a “beep” sound will be generated and then switch to the standby mode automatically, the display will show “_ _ _ _”

CLEAN AND MAINTENANCE

- Ensure the appliance is turned off and unplug the power cord from the wall socket.
- The removable inner metal pot and glass lid can be washed in warm soapy water with a soft cloth or sponge.
- Do not use an abrasive cleaner to clean all the removable parts and the appliance.
- Do not put the removable parts in a dishwasher.
- Please note, the accessories are not dishwasher safe.
- The Main Housing of the appliance can clean with a damp cloth.
- Do not immerse the Main Housing and Base tray and power cord into water or any other liquids.

Warning: Ensure the appliance is cooled down completely before cleaning.

TECHNICAL SPECIFICATION

Description: 10-in-1 Multi-Functional Cooker

Model number: GMC15V

Input Voltage: 220-240V

Frequency: 50Hz

Power : 1500W

Product dimension: 355(W) x 295 (H) x 350 (D)mm

閱讀下列說明事項並請妥善保管，以供日後參考。

一般安全

在使用本產品之前，應仔細閱讀下列事項及使用說明，閱後並請妥善保管，以供日後參考：

- 請按照這些說明事項 使用本產品。
- 本產品僅供家用，不作商業用途。
- 使用前，請將所有包裝材料。
- 0至8歲的兒童不應使用本產品。
- 超過8歲的兒童可使用本產品，但請勿由肢體不健全、感覺或精神上有障礙或缺乏相關經驗和知識的人使用，除非有負責他們安全的人對他們使用本產品進行監督或指導。
- 請務必看顧好兒童，以確保他們不玩耍本產品。
- 兒童不應清潔或維修本產品。
- 當需進行任何維修，必須由專業維修人員進行維修。永遠不要嘗試自己修理本產品。

安全指引-電子和熱能產品

- 使用相符的電源和電壓，以防止觸電。
- 本產品只能使用帶接地線的電源插座。
- 當本產品不使用時，請從牆上的插座中拔掉插頭。
- 從牆上插座中拔掉插頭時，應拿著插頭而不是電源線。
- 確保本產品、電源線和插頭不與水接觸。
- 確保本產品、電源線和插頭不接觸發熱表面，如明火。
- 定期檢查本產品的電源線以確保其未損壞。如果電源線損壞，請勿使用其產品，並須由專業維修人員來更換，以避免出現任何險。
- 使用延長線時，務必確保整個電纜從捲軸上退出。
- 只使用符合標準的電源線。
- 確保本產品的周圍有足夠空間，並且不接觸易燃物料。使用時，通風口不得覆蓋或堵塞。
- 切勿在易燃材料附近使用本產品。
- 本產品的某些部分可能會發熱。不要觸摸這些部分，以防止燙傷自己。

注意：當使用本產品時，不要觸摸玻璃蓋和金屬內鍋，以免燙傷。

注意：在第一次使用本產品時，會有輕微的煙霧，均屬正常的。不久後，將會消失。

注意：內鍋的發熱管有可能在操作時，受到熱脹冷縮情況下，發出“嗶叭”聲響，這是安全及正常的，請放心使用。

安全介紹 - 操作期間

- 切勿在室外使用本產品。
- 切勿在潮濕的房間使用本產品。
- 請勿用潮溼的手插拔電源插頭或按壓操作面板上的任何按鈕。
- 將本產品放在一個平坦、穩固的表面上，且不易滑落。
- 切勿讓電源線懸掛在邊緣或櫃檯、檯面或桌面上。
- 如果本產品落入水中，立即從插槽中拔下插頭，並且不要再次使用本產品。
- 切勿將本產品、電源線或插頭浸入水中或其他液體中。
- 使用後徹底清潔本產品(請參閱“清潔和保養”)
- 請勿將本產品連接至外置計時器或遙機器，以免發生危險。

產品結構

1. 玻璃蓋手柄
2. 玻璃蓋
3. 金屬內鍋
4. 機身手柄
5. 底座托盤
6. 控制面板
7. LED 顯示屏



配件

注意: 配件不可放於洗碗碟機清洗。

1. 炸籃 x 1個



裝拆炸籃圖示 -

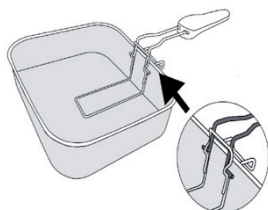

油炸完成,可將炸籃後面的“掛鉤”裝在金屬內鍋上,以便把食物中多餘的油份排去。

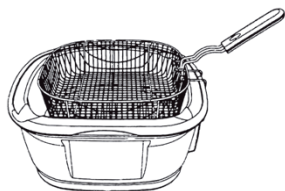

2. 蒸架 x 1個



裝拆蒸架圖示 - 蒸煮烹飪時,將蒸架放在金屬內鍋的4個支撐槽上。

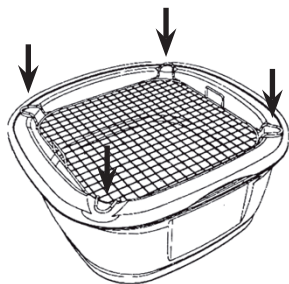

3. 燒烤架x1個

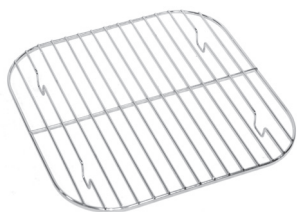

裝拆燒烤架圖示 - 燒烤烹飪時，將燒烤架放在金屬內鍋上。

控制面板

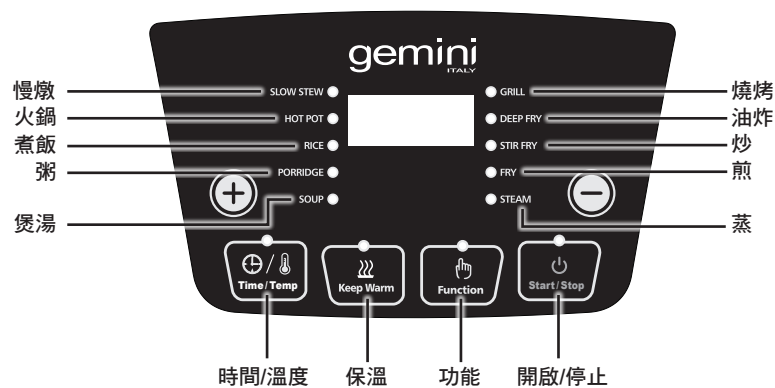

裝拆方法

1. 把手柄裝上玻璃蓋，簡單步驟說明

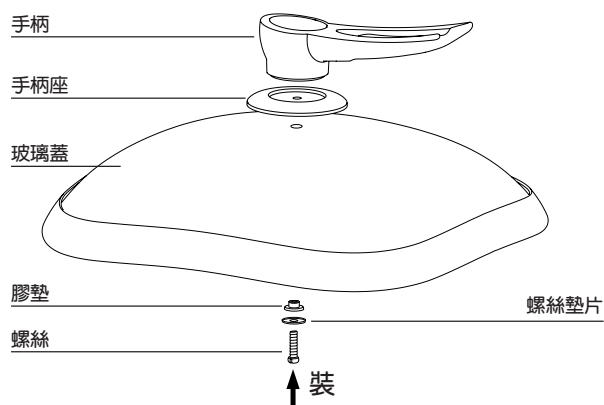

2. 金屬內鍋裝拆方法

- 使用前請取出墊在金屬內鍋的發泡膠包裝
- 拆裝內鍋前請確認產品已斷開電源！
- **拆除**：用手提住不粘鍋左右凹位置，然後用力向上提起內鍋
- **裝嵌**：將內鍋底部四支金屬導柱和三支電極棒對準托盤上的相應孔位，往下按壓內鍋直至到底
- 完成裝配後，本產品便可使用。

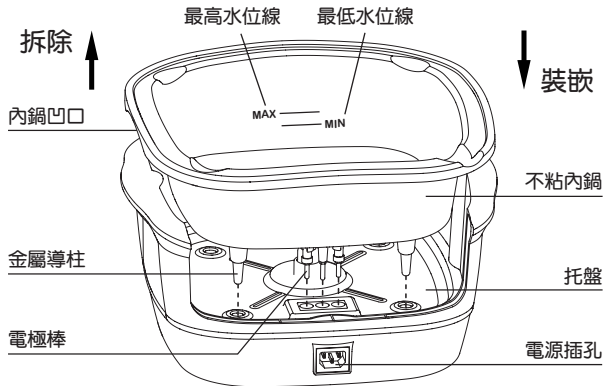

使用說明

- 將插頭接通本機電源。會發出“嗶-”聲。LED 顯示屏會亮起及顯示“----”，即已進入了待機模式。
- 按下“功能”按鍵，選擇不同烹飪程式。
- 所有食材及水不得超越金屬內鍋的最高水位線 (MAX.)。
- 食材及水必需達致最低水位線 (MIN.)
如慢燉、火鍋、煮飯、粥、煲湯、油炸和蒸
- 選定烹飪程式後，預設的煮食時間及溫度會顯示在LED顯示屏上。您也可以調整所需時間或溫度 (如需要)。不同烹飪程式的預設時間和溫度範圍可調較範圍如下：

程式	預設程式		客戶自行調整的時間及溫度	
	烹飪時間 (小時:分鐘)	溫度	烹飪時間 (小時:分鐘)	溫度
慢燉	06:00	100°C	0:01-5:59	不能調整
火鍋	02:00	240°C	0:01-1:59	120-240°C
煮飯	00:35	150°C	不能調整	
粥	01:00	110°C	0:01-1:30	100-140°C
煲湯	01:00	110°C	0:30-2:00	不能調整
燒烤	00:30	240°C	0:01-9:59	180-240°C
油炸	00:30	180°C	0:01-9:59	180-240°C
炒	00:15	240°C	0:01-0:30	50-240°C
煎	00:25	200°C	0:01-0:59	50-240°C
蒸	00:15	220°C	0:01-1:59	100-220°C

- 按“時間/溫度”按鍵切換時間和溫度設定：
 選取烹煮程序後，調整烹飪時間(如需要) - 按下控制面板上的“時間/溫度”按鍵1次，LED顯示屏會閃動，然後按“+”或“-”按鍵調節所需時間。
 選取烹煮程序後，調整烹飪溫度(如需要) - 按下控制面板上的“時間/溫度”按鍵1次，LED顯示屏會出現單位“C”，然後按“+”或“-”按鍵調節所需溫度。
- 當選擇適當烹飪時間和烹飪溫度後，請按“開始/停止”按鍵1次以啟動烹飪程式。
- 如果在烹飪過程中按下“開始/停止”按鍵，則設置程式會被取消，然後將進入待機模式。

保溫功能

- 當本機處於待機模式時，按下“保溫”按鍵以啟動保溫功能。
- 保溫顯示燈將亮起，顯示為“bb”。首6小時保溫溫度可維持約60°C- 80°C。
- 要取消保溫設置，請再次按“保溫”按鍵。
- 烹飪程式完成後，會自動切換到保溫功能，2小時後，將會自動切換到待機模式。

不同的烹飪程式

- 產品提供了10種烹飪程式。按下“功能”按鍵，選擇一個適當烹飪程式：
 慢燉、火鍋、煮飯、粥、煲湯、燒烤、油炸、炒、煎和蒸
- 當您選擇了烹飪程式後，相應的指示燈將會亮起及預設時間及溫度已設定，可按“開啟/停止”鍵進行煮食。
- 你亦可按“時間/溫度”按鍵，根據您的烹飪程式來調整時間和溫度。
- 按“開始/停止”按鍵1次以啟動烹飪程式。相應的指示燈將會亮起。
- 一旦選擇並啟動了烹飪程式，在完成該烹飪程式之前，不能選擇其他烹飪程式。但可隨時調整烹飪時間和溫度。
- 一旦你選擇了所需烹飪程序，紅色指示燈將亮起。
- 烹飪程式可以通過在烹調過程中的任何時間按下“開啟/停止”鍵來停止。選定的程式將被取消。
- 您還可以在待機模式下調整烹飪程式。調整烹飪程式後，“開啟/停止”鍵，再次重新啟動烹飪程式。
- 烹飪程式完成後，會發出“嗶”聲，並自動切換到保溫功能，2小時後，會發出“滴滴”聲，然後自動切換到待機模式，顯示屏顯示“_ _ _ _”。

清潔和保養

- 不使用時，確保產品已關閉，並從牆上插座拔下電源線。
- 可拆卸金屬內鍋和玻璃蓋，可在肥皂水中清洗及用軟布或海綿清洗。
- 在可拆卸配件上，不能使用清潔劑。
- 不可將拆卸配件放入洗碗碟機清洗。
- 請注意，配件不可使用洗碗機清洗。
- 本產品的外殼，可以用濕布抹擦。
- 本產品外殼和底座托盤，不可浸入水中或接觸到其他液體。

注意：確保產品在使用前冷卻

產品規格

名稱：10合1 功能煮食鍋

型號：GMC15V

輸入電壓：220-240V

頻率：50Hz

功率：1500W

產品尺寸：355 (闊) x 295 (高) x 350 (深) 毫米

請記錄下列產品資料

- 型號

- 機身編號

- 經銷商名稱

- 購買日期

本產品不斷改進中，如功能有所更改，恕不另行通知，如有疑問，請與客戶服務中心聯絡，不便之處，敬請原諒。

說明書內容以英文版本為準

ToolBox Customer Service Centre 客戶服務中心：
4/F, DCH Building, 20 Kai Cheung Road, Kowloon Bay, Hong Kong
香港九龍灣啓祥道20號大昌行集團大廈4樓

Customer Service Hotline 客戶服務熱線：(852) 8210 8210
Service E-mail 電郵地址：8210service@gilman-group.com
Please register now at 請即上網登記：www.toolbox.hk
Website 網址：www.gilman-group.com



Proudly Serviced by:



太平家庭電器