

gemini
ITALY

**HANDHELD
GARMENT
STEAMER**

手提蒸熨機

MODEL NO.: GGS150TT

1500W



A GILMAN GROUP BRAND

Please read and retain for future reference.

SAFETY INSTRUCTION - GENERAL

- Use this appliance solely in accordance with these instructions.
- This appliance is for household use only, not for commercial purpose.
- Remove all packaging material from the appliance before use.
- This appliance shall not be used by children of 0 to 8-year old.
- This appliance can be used by children older than 8-year old and persons with reduced physical, sensory or mental capabilities or lack of experience and knowledge, but only if they have been given supervision or instruction concerning use of the appliance in safe way and understand the hazards involved.
- Children should be supervised to ensure that they do not play with the appliance.
- Cleaning and maintenance must not be done by children.
- Have any repairs carried out solely by a qualified electrician. Never try to repair the appliance yourself.
- Do not handle the plug or appliance with wet hands.
- Do not immerse the main body in water.
- Children shall not play with the appliance.
- Do not leave the appliance unattended when connected to the mains supply.
- Keep hair, loose clothing, fingers and all parts of the body away from openings of the appliance.
- Only use the attachments/accessories supplied with the product.

SAFETY INSTRUCTION - ELECTRICITY AND HEAT

- Verify that the mains voltage is the same as that indicated on the rating plate on the appliance before use.
- Make sure that you always use a grounded wall socket to connect the appliance.
- Always remove the plug from the wall socket when the appliance is not in use.
- Remove the plug from the wall socket by pulling the plug, not the power cord.
- Make sure that the appliance, the power cord and plug do not make contact with water.
- Make sure that the appliance, the power cord and plug do not make contact with hot surface, such as a hot hob or naked flame.
- Do not use the appliance if the power cord is damaged. If the power cord is damaged, it must be replaced by an electrical technician or a person with similar qualification, in order to avoid any hazards.
- Never use the appliance in the vicinity of flammable material.
- Certain part of the appliance may get hot, such as air outlet. Do not touch these part to prevent scalding yourself.

Warning: Do not touch the hot surfaces of the steamer head when the appliance is in use.

SAFETY INSTRUCTION - DURING OPERATION

- Make sure your hands are dry before touching the appliance, power cord or plug.
- Do not pick up the appliance if it falls into water. Remove the plug from the socket immediately. Do not use the appliance again.
- Never immerse the appliance, the power cord or the plug in water or any liquid.
- Clean the appliance thoroughly after use (Please refer to “Cleaning and Storage” section).
- To avoid injury from high temperature steam, do not keep the spray head face yourself or anybody while steaming.
- After use, unplug the steamer and empty any remaining water from the tank to avoid leakage or calcification.

Warning: Do not attempt to attach or remove the brush attachments while the unit is steaming or hot. Wait until the unit is completely cooled.

PRODUCT OVERVIEW

1. Stainless steel steam head
2. Steam button
3. Water tank release button
4. Water tank
5. Power ON/OFF button with power indicator light
6. Power cord
7. Fabric brush
8. Hair brush
9. Line clip
10. Measuring cup
11. Storage bag

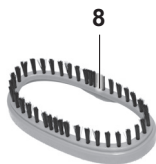
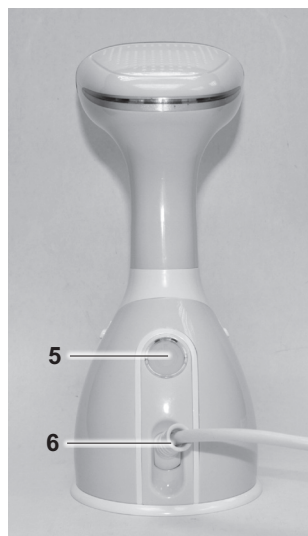

ASSEMBLY INSTRUCTION

Caution: Always let the steamer cool down before assembling the attachments.

Hair brush

- Hair brush for removing hair from clothes.
- Align the bottom protruding part of the hair brush into the bottom groove of the steam head.
- Push the head of the hair brush until the top protruding part also clicks in the top groove of the steam head.

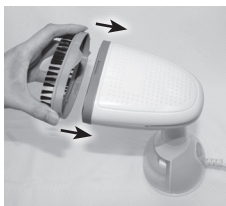

Fabric brush

- Fabric brush for removing dust and dirt from clothes.
- Align the bottom protruding part of the lint brush into the bottom groove of the steam head.
- Push the head of the fabric brush until the top protruding part also clicks in the top groove of the steam head.



Line clip

- Line clip for shaping edges of collar, cuff and trousers.
- Align the bottom protruding part of the line clip into the bottom groove of the steam head.
- Push the head of the line clip until the top protruding part also clicks in the top groove of the steam head.

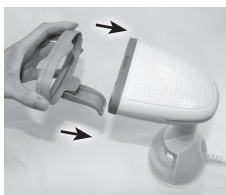

USAGE INSTRUCTION

Caution: Hot surface of steam head during operation!

Filling:

Press the water tank release buttons on left and right side simultaneously (Pic.1), pull out the water tank, open the water inlet cover. Use the supplied measuring cup for adding suitable amount of water, fill the water into the water tank until it reaches the MAXIMUM level (280ml) (Pic.2). Do not exceed the MAXIMUM mark line (about 280ml). Close the water inlet cover and put back the water tank in machine.

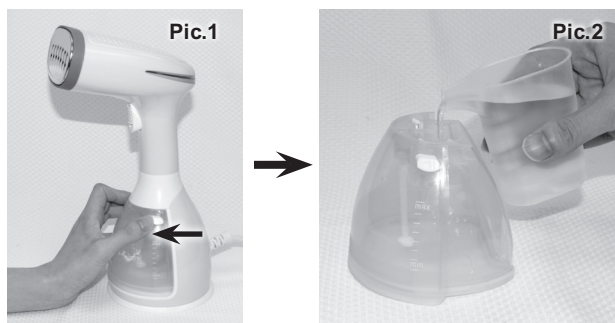

Drainage:

Press the water tank release button, pull out the water tank, open the water inlet cover, drain the remaining water (Pic.3) and close the water inlet cover and put back the water tank in machine.

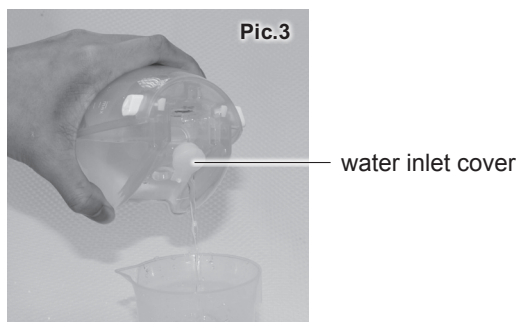

STEAM BUTTON INSTRUCTION

The steam button switch is well-designed, a combination function modes of PRESS TO STEAM and CONTINUOUS STEAM, easy to change two steam modes.

- When the lock of the steam button is pushed upward, the machine is in the PRESS TO STEAM mode, the button can be pressed directly. At this point, press the button will steam out, release the button will stop the steam. (Pic.4)
- When press the button and the lock is pushed downward, the machine is in the CONTINUOUS STEAM mode (Pic.5) if it needs to stop the steam, just need to push the lock of button upward. (Pic.4)



Pic.4



Pic.5

(Press to steam mode)

(Continuous steam mode)

OPERATION INSTRUCTION

- Check the steam button first to ensure that the lock is in an upward state (Pic.4) and there will be a water spray if the temperature has not been reached.
- Hang your garment or fabric in appropriate position.
- The Max. water level on the water tank is about 280ml. Fill the water tank and close the inlet cover before operating and assemble the accessory which you need, insert the plug into a power socket.
- Press the power button, the power indicator light will be flashing, wait until the light stops flashing (approximately 15 seconds). When the light is steady light up the appliance is ready to use. Switch OFF the steamer by press the power button. When the appliance is power off the indicator light will extinguish.
- To stop the flow of steam, just release the steam button to unlock state.

Warning:

- When the water tank is lack of water, the strange sound of the pump may be heard. Please stop operating immediately, unplug the power cord and fill the water again.
- Do not use this machine upside down.



STEAMING TIPS:

- When using the device for first time, please test it on an old cloth, as there may be sediment left from the manufacturing process or transportation.
- Pass the steam jets just above the fabric where the wrinkles are. It may take a few passes to remove the wrinkles completely.
- When hanging garment on a door while steaming, be careful not to damage the door with steam. Please select a suitable place to hang your clothes.
- Test fabric for color fastness in an inconspicuous spot. Drape linens, towels, handkerchiefs and napkins over a rod or place onto a towel rack.

CLEANING AND STORAGE

Tips: Always clean the steamer and accessories after using.

- Release the steam on/off button and unplug, wait until the machine is totally cooled down.
- Take off the installed accessories and clean them with a cloth or soft brush and let them dry completely.
- Open the top's water inlet cover of the tank, discharge the remaining water, restore the water inlet cover and wipe the tank clean. (Pic.3, please refer to "USAGE INSTRUCTION - Drainage)
- Gently wipe the unit with a soft cloth, pack with the storage bag and put in a dry and cool place.
- Put the appliance and all accessories into the supplied bag for storage.

DECALCIFICATION

- Use a solution of 1/3 white vinegar and 2/3 water in the water tank.
- Plug the unit into electrical outlet, press power button, wait until the blue light goes on then push the steam button and the lock is pushed downward, wait for the mixture to boil for 5 minutes. Release the steam button, unplug from electrical outlet and discard the mixture.
- After 10 hours, run one cycle of distilled water through the appliance at the completion of decalcification before using the appliance again to steam garments.

Caution: Do not clean with corrosive, scouring powder, detergent or hard goods (eg. Knife or steel ball) .

OVERHEAT PROTECTION

The power will automatically shut off after 8 minutes if you have not any operations after the unit is plugged into the electrical outlet and turned on.

TROUBLESHOOTING

PROBLEM	CAUSE	SOLUTION
No steam	Steamer is not turned on	Press the steam on button
Steamer fails to heat	Steamer is not plugged in	Plug into electrical outlet
No steam	Water level is low	Unplug the steamer and refill water tank
Poor steam performance	Sediment in tank	Decalcify water tank

*If problem exists after trying with the solution, please contact our After-Sales Service Center for assistance.

PRODUCT SPECIFICATIONS

Model no.: GGS150TT

Voltage: 220-240V~

Frequency: 50Hz

Output power: 1500W

Product dimensions: 113(W) x 276(H) x 160(D) mm

* The final product specification may be varied according to a different lot of material and actual input voltage power of the usage area.

閱讀下列說明事項並請妥善保管，以供日後參考。

安全指引 - 一般安全

- 請按照這些說明事項, 使用本產品。
- 本產品僅供家用，不作商業用途。
- 使用前，請將所有包裝材料拆除。
- 0至8歲的兒童不應使用本產品。
- 超過8歲的兒童可使用本產品，但請勿由肢體不健全、感覺或精神上有障礙或缺乏相關經驗和知識的人使用，除非有負責他們安全的人對他們使用本產品進行監督或指導。
- 請務必看顧好兒童，以確保他們不玩耍本產品。
- 兒童不應清潔或維修本產品。
- 當需進行任何維修，必須由專業維修人員進行維修。永遠不要嘗試自己修理本產品。
- 手濕時不可以接觸電源插頭或本機。
- 主機不可以浸入水中。
- 兒童不可以把玩本機。
- 本機開著後不可以無人監管。
- 當本機開著時，頭髮、鬆身衣物、手指和身體其他部份都要離開本機。
- 只使用隨機附送的配件。

安全指引 - 電子和熱能產品

- 使用相符的電源和電壓，以防止觸電。
- 本產品只能使用帶接地線的電源插座。
- 當本產品不使用時，請從牆上的插座中拔掉插頭。
- 從牆上插座中拔掉插頭時，應拿著插頭而不是電源線。
- 確保本產品、電源線和插頭不與水接觸。
- 確保本產品、電源線和插頭不接觸發熱表面，如明火。
- 定期檢查本產品的電源線以確保其沒有損壞。如果電源線損壞，請勿使用其產品，並須由專業維修人員來更換，以避免出現任何危險。
- 切勿在易燃材料附近使用本產品。
- 本產品的某部分可能會發熱。不要觸摸這些部分，以防止燙傷自己。

注意：當使用本產品時，不要觸摸蒸燙頭，以免燙傷。

安全指引 - 操作期間

- 請勿用潮溼的手插拔電源插頭或接觸本產品。
- 如果本產品落入水中，立即從插槽中拔下插頭，並且不要再次使用本產品。
- 切勿將本產品、電源線或插頭浸入水中或其他液體中。
- 使用後徹底清潔本產品 (請參閱“清潔和保養”)
- 在熨衣過程中，請始終保持蒸燙機的蒸氣出口不要面向自己或其他人，避免蒸氣高溫造成傷害。
- 每次使用完畢後，記得拔掉插頭並把水箱內剩餘的水從水箱底部排出, 避免漏水及產生水垢，影響使用。

部件示意圖

1. 不銹鋼蒸氣頭
2. 蒸氣開關鍵
3. 水箱釋放按鈕
4. 水箱
5. 電源開/關鍵及指示燈
6. 電源線
7. 絨毛刷
8. 長毛刷
9. 褲線夾
10. 量杯
11. 儲存袋

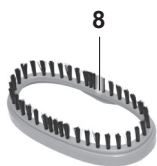
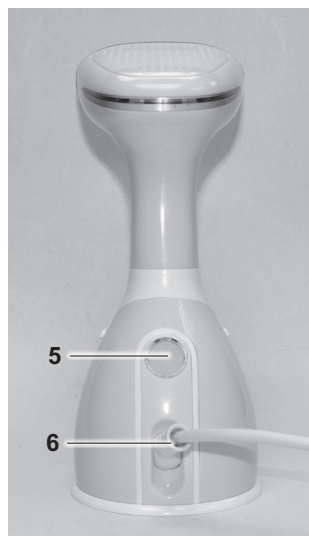

安裝說明

注意：請必須待蒸熨機冷卻後才可更換或者卸下配件。

長毛刷的裝配：

- 長毛刷可以用於掃除衣物上的頭髮
- 將長毛刷頂部的凸點對準裝入蒸氣頭的頂部凹槽內。
- 然後用力按下長毛刷的底部，使長毛刷底部的凸點裝入蒸氣頭頂部的凹槽內即可使用。

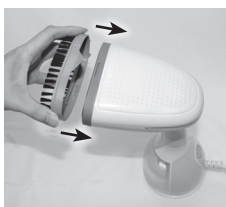

絨毛刷的裝配：

- 絨毛刷可以用於掃除衣物上的微塵及污垢。
- 將絨毛刷頂部的凸點對準裝入蒸氣頭的頂部凹槽內。
- 然後用力按下絨毛刷的底部，使絨毛刷底部的凸點裝入蒸氣頭頂部的凹槽內即可使用。



褲線夾的裝配：

- 褲線夾可以用於定型褲腳及袖口。
- 將褲線夾頂部的凸點對準裝入蒸氣頭的頂部凹槽內。
- 然後用力按下褲線夾的底部，使褲線夾底部的凸點裝入蒸氣頭頂部的凹槽內即可使用。

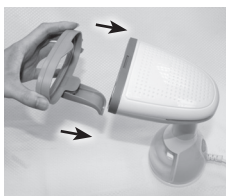

使用說明

注意：蒸氣頭在操作中會產生熱力，請不要觸摸！

注水：

按下水箱釋放按鈕(圖1)，拉出水箱並打開進水蓋子。使用附機的量杯加入適量的水，將水倒入水箱，直至達到最高水位 (280ml) (圖2)。不要超出最高MAX水位線 (280ml)。蓋上蓋子將水箱安裝回機身。

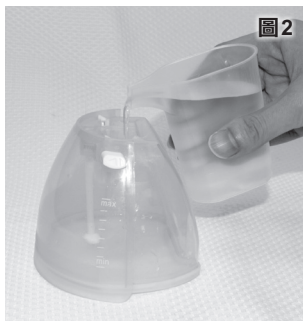

排水：

按下水箱釋放按鈕，拉出水箱並打開進水蓋子，排出剩餘的水量 (圖3)，蓋上蓋子將水箱安裝回機身。



進水蓋子

蒸氣開關說明

- 本款機器精心設計了蒸氣開關操作模式，連續蒸氣及按壓蒸氣操作，輕鬆變換2種出蒸氣模式。
- 若蒸氣按鍵沒鎖上，此為按壓蒸氣模式，可以直接按下蒸氣開關，這時按下就噴蒸氣，鬆開就停止噴蒸氣。(圖4)
- 開關鍵推向下為持續出蒸氣模式，在按下蒸氣開關的同時，將開關鍵推下鎖緊，即可鎖定持續出蒸氣操作。(圖5) 當需要關閉時，只需要將開關鍵推上鎖緊(圖4)，便停止出蒸氣。



圖4

(按壓蒸氣模式)



圖5

(連續蒸氣模式)

使用說明

- 先檢查下蒸氣開關鍵，確保其鎖扣處於向上狀態(圖4)，需待加熱完畢後，才開始使用。
- 請在適當的位置掛起您的衣物或織物。
- 蒸熨機水箱上的最高水位線約280毫升，開啟前注入水及蓋緊水箱蓋，並安裝好所需的配件，然後將電源插頭插入電源插座。
- 按下電源按鈕，電源指示燈將閃爍，等待指示燈停止閃爍(約15秒)，便可以開始使用。當再次按電源按鈕時，可以關掉蒸燙機，此時指示燈將熄滅若需要停止噴出蒸氣，請鬆開手柄上的蒸氣開關鍵。

警告：

- 水箱因缺水情況下，可能會出現水泵抽空的聲響，需馬上停止工作，拔掉插頭，給水箱注水。
- 請勿倒立使用本機。



注意事項

- 當第一次使用蒸熨機時，請於舊衣服上作測試，因為蒸熨機可能有製造過程中或運輸中遺留的污垢。
- 衣物上有皺紋的地方，可能需要連續噴出蒸氣 數次才能完全消除。
- 當在門上掛上服裝蒸熨時，強熱的蒸氣是會可能損壞門面，請選擇合適掛衣物的地方。
- 請於衣物表面不顯眼的地方測試顏色牢固度，蒸熨亞麻布窗簾、毛巾、手帕、餐巾時，請放於桿子或者毛巾架上進行蒸熨。

清潔和保養

提示：每次使用後，請清潔本機。

- 拔下插頭，等待本機徹底冷卻。
- 拆下安裝上去的配件，用布或者柔軟的刷子清潔乾淨並晾乾。
- 打開水箱頂部蓋子，排出剩餘的水量，將蓋子復原並將水箱擦拭乾淨。
(圖3，請參閱“使用說明-排水”)
- 可用柔軟潔布輕輕擦拭蒸熨機表面，並將清潔後的機器放進袋子置於陰涼通風的地方。
- 將本機及所有配件放入隨機的袋子，以便儲存。

清除水垢的方法

- 請混合三份一白醋及三份二清水並注入水箱。
- 插上電源，按下電源開關鍵，待指示燈停止閃動並亮起，按下蒸氣開關鍵的同時，將開關鍵推下鎖緊，再將水醋混合物煮沸5分鐘，然後關機並丟掉混合物。
- 10小時後，用清水重複以上步驟一次後，才進行蒸熨衣物。

過熱保護裝置

如果您插上電源並按下電源開/關鍵後，沒有任何操作，8分鐘後自動斷開電源。

疑難排解

問題	原因	解決方法
無蒸氣噴出	並未開機	按下手柄上的開關鍵
蒸熨機不發熱	並未插上電源	插上電源
無蒸氣噴出	水箱內水位低或缺水	拔掉插頭，並注入過濾的清水
蒸氣不流暢的噴出	水垢積聚於水箱內	清除水垢

*如試了以上方法都不能解決問題，請聯繫售後服務部協助。

產品規格

型號：GGS150TT

電源：220-240V~

頻率：50Hz

熱量輸出：1500瓦

產品尺寸：113(闊) x 276(高) x 160(深) 毫米

* 相關產品的規格，可能會因配件批次或實際使用地區的電壓差異而有所不同。

請記錄下列產品資料

- 型號

- 機身編號

- 經銷商名稱

- 購買日期

本產品不斷改進中，如功能有所更改，恕不另行通知，如有疑問，請與客戶服務中心聯絡，不便之處，敬請原諒。

說明書內容以英文版本為準

ToolBox Customer Service Centre 客戶服務中心：
4/F, DCH Building, 20 Kai Cheung Road, Kowloon Bay, Hong Kong
香港九龍灣啓祥道20號大昌行集團大廈4樓

Customer Service Hotline 客戶服務熱線：(852) 8210 8210
Service E-mail 電郵地址：8210service@gilman-group.com
Please register now at 請即上網登記：www.toolbox.hk
Website 網址：www.gilman-group.com



Proudly Serviced by:



太平家庭電器