

CELLINI^{italy}

AC/DC RECHARGEABLE ULTRASONIC MIST FAN WITH IONIZER

INSTRUCTION MANUAL

MODEL NO.: CMF250R

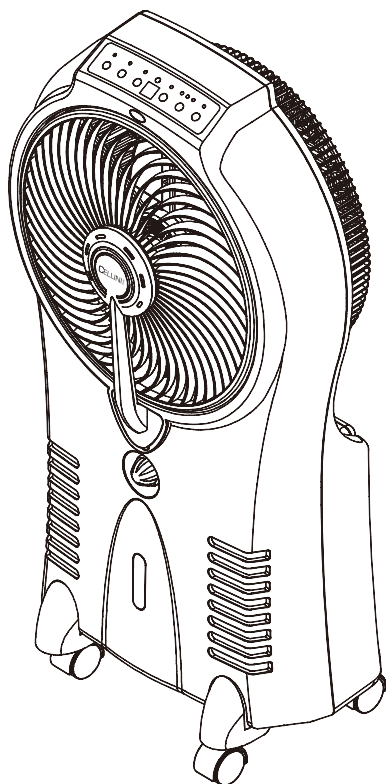

WARNING:

- (1) The battery must always be stored at full state-of-charge. Low charge causes sulfating, a condition that robs the battery of performance and shorten the cycle life, as self-discharge will eventually completely discharge the battery and damage it. Thus this battery should always be charged after use and charged every month if stored unused for extend period.
- (2) To keep the battery in good condition, apply a fully saturated charge lasting 14 to 16 hours. If the charge cycle does not allow this, give the battery a fully saturated charge once every few weeks.

CAUTION:

1. please turn ON the main on/off switch at the rear cabinet BEFORE use.
2. please turn OFF the main on/off switch at the rear cabinet when not in use.

FEATURES

1. Timer ON Indicator
2. Ionizer ON Indicator
3. Misting ON Indicator
4. Fan Oscillation Indicator
5. Fan Low Speed Indicator
6. Fan Medium Speed Indicator
7. Fan High Speed Indicator
8. Power ON/Battery Charging Indicator
9. Timer Button
10. Ionizer Button
11. Misting ON/OFF Button
12. Timer & Temperature Display
13. Fan Oscillation Button
14. Fan Speed Button
15. Fan Power ON/OFF Button
16. Remote Controller Sensor
17. Misting Outlet
18. Misting Volume Control
19. Water Level Indicator
20. Wheel
21. Drain Plug
22. Rotary Fan Grill
23. Handle
24. Main Power ON/Off Switch
25. Battery Compartment cover
26. Detachable Water Tank
27. Remote Controller Power ON/OFF Button
28. Remote Controller Fan Oscillation Button
29. Remote Controller Misting ON/OFF Button
30. Remote Controller Timer Button
31. Remote Controller Fan Speed Button
32. Remote Controller Ionizer On Button
33. Remote Controller Battery Flap
34. Battery (inside battery compartment)

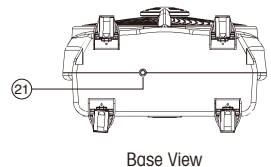
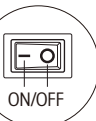
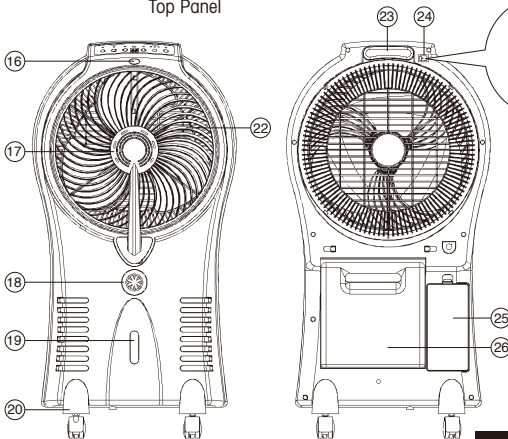
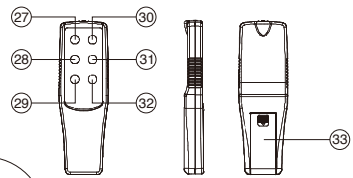
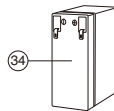
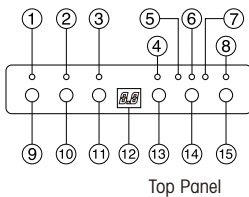

CAUTION
RISK OF ELECTRIC SHOCK
DO NOT OPEN

CAUTION: TO PREVENT ELECTRICAL SHOCK OR FIRE HAZARD, DO NOT EXPOSE THIS PRODUCT TO RAIN OR MOISTURE OR REMOVE BACK COVER. NO USER-SERVICEABLE PARTS INSIDE. REFER SERVICING TO QUALIFIED SERVICE PERSONNEL.

This marking indicates that this product should not be disposed with other household wastes throughout the EU. To prevent possible harm to the environment or human health from uncontrolled waste disposal, recycle it responsibly to promote the sustainable reuse of material resources. To return your used device, please use the return and collection systems or contact the retailer where the product was purchased. They can take this product for environmental safe recycling.

WARNING:

- A. To avoid an electrical shock, please do not open the rear cabinet for repair or cleaning unless qualified person.
- B. If the supply cord is damaged, it must be replaced by the manufacturer or its service agent or a similarly qualified person in order to avoid a hazard.
- C. The appliance is not intended for use by persons (including children) with reduced physical, sensory or mental capabilities, or lack of experience and knowledge, unless they have been given supervision or instruction concerning use of the appliance by a person responsible for their safety.
- D. Children should be supervised to ensure that they do not play with the appliance.

The lightning flash with arrowhead symbol, within an equilateral triangle, is intended to alert the user to the presence of uninsulated, "Dangerous Voltage" within the product's enclosure that may be of sufficient magnitude to constitute a risk of electric shock to persons.

The exclamation point within an equilateral triangle is intended to alert the user to the presence of important operating and maintenance (servicing) instructions in the literature accompanying the appliance.

WARNING: TO REDUCE THE RISK OF FIRE OR ELECTRIC SHOCK, DO NOT EXPOSE THIS APPLIANCE TO RAIN OR MOISTURE

PRODUCT INTRODUCTION

The AC/DC rechargeable ultrasonic mist fan is designed with digital control system. It has device for storing water. It can lower surrounding temperature, freshen the air with equipped ion humidify the air through the principle of water misting. LED panel makes it easy to use. It enables both corded and cordless operation.

IMPORTANT NOTES

Please read the instruction manual carefully before operating this unit.

1. Make sure that the home power supply consistent with the product before plug in.
2. Switch off and disconnect from the power outlet when not in use or before cleaning.
3. Unplug from power source when not in use unless recharging.
4. Do not expose the unit to rain and keep out of reach of water on the control panel or LED for proper use.
5. Do not put the fingers or any objects inside the fan grill during operation.
6. Do not operate the unit if there is any damage to the power plug or cord - take the unit to our after sales service center for repair, do not attempt to undertake any required repairs yourself.
7. Wipe clean with damp cloth only - do not use any abrasive cleaners.
8. This appliance is not intended for use by persons (including children) with reduced physical, sensory, or mental capabilities or lack of experience and knowledge unless then have been given supervision or instruction concerning use of the appliance by a person responsible for their safety.
9. Please recharge the unit when power is low.
10. Do not use the misting mode when water tank is empty; water level in must be above minimum level for this function to operate, otherwise it may cause water pump malfunction.
11. Switch off the functions when the battery is being charged. Otherwise will lower the efficiency of charging.
12. Please charge the battery 14 to 16 hours every month even the unit will not be used. In absence of charging over long period of time, the battery will be malfunction and damaged.
13. Do not use the misting function if unit is to be used in a damp place.
14. If unit is being stored up for a long period of time without use, empty the water tank before storing or transporting the unit.

HOW TO ASSEMBLE THE WHEELS (SEE DRAWING 1)

1. Attach the four wheels to the base, then insert the four assembled bases into the unit.

2. Tightening the screws with a screwdriver in a clockwise direction.
3. Wheels can be locked in position if required.

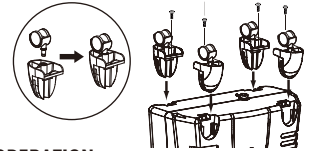

DRAWING 1

POWER ON/OFF OPERATION

Make sure that the home power supply is consistent with the product before plug in. Firstly, turn on the main power ON/OFF switch at the rear (Feature 24) and press the "fan power ON/OFF button"(Feature No. 15) on the control panel or (Feature No.27) on the remote controller to start operation, then the LED light (Feature No.8) will become illuminated on the control panel and follow the fan speed operation below. Press the same button to turn off the function.

** For cordless (DC) operation, please refer to section "About the rechargeable battery".

FAN SPEED OPERATION

Select the required fan speed to Low/Medium/High by pressing the "Fan Speed Button"(Feature No. 14) on the control panel or (Feature No. 31) on the remote controller. The LED light of selected speed will become illuminated on the control panel and the set speed will be memorized and kept unit the next operation.

MISTING OPERATION

1. Ensure the unit is placed on a level surface and unplug from the power and switch off all the function when refilling water.
2. Remove the water tank (Feature No.26) and fill water, but do not fill water over the Marking Line (see drawing 1 below) to ensure water does not overflow.

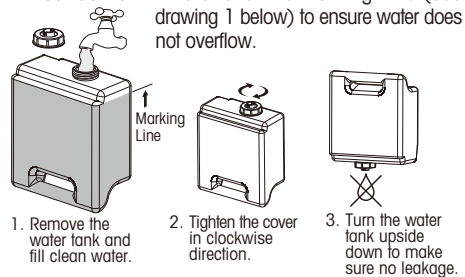

1. Remove the water tank and fill clean water.
 2. Tighten the cover in clockwise direction.
 3. Turn the water tank upside down to make sure no leakage.
 4. Put the water tank back to the unit.
3. Misting function will not operate effectively if water not enough.
 4. Connect to the power socket, turn on the main switch

and press fan power ON/OFF button, select the fan speed to start and press "Misting ON/OFF Button" (Feature No.11) on the control panel or (Feature No.29) on the remote controller to switch the misting on or off; illuminated lights on the control panel will indicate the functions currently in operation.

- Adjust the mist density, turn the "misting control volume" (Feature No.18) clockwise to increase the mist density or anti-clockwise to decrease the mist density, then get an optimum mist performance as required.
- It may take a minute for a new misting fan to start the misting, it is normal for air to come out of the nozzles before water and the mist.



- Press the "Fan power ON/OFF" button.
- Select the Fan Speed to start.
- Press the "Misting ON/OFF" to start misting.

- Adjust the mist density by turning the "Misting volume control".

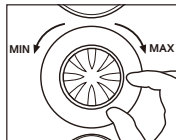

Warning :

- Low Water Level Alarm: when water level becomes low, you will hear the "beep" sound and the "Mist Indicator" will flash continuously. At the same time the power of the pump inside the unit will be cut off to protect the life of the pump. To stop the alarm, turn off the unit from the power outlet. Fill the tank with water and turn on the unit again.
- DIRECT POUR WATER INTO MIST FAN IS PROHIBITED. (SEE DRAWING 2)**

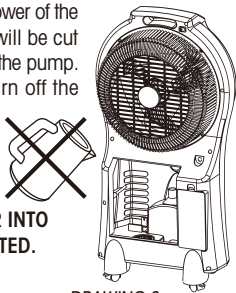

DRAWING 2

OSCILLATION OPERATION

To start 360° air flow direction, press the "Fan Oscillation Button" (Feature No. 13) on the control panel or (Feature No. 28) on the remote controller once; LED light (Feature No.4) will become illuminated on the control panel and the rotary fan grill will begin to rotate, directing air in a full circle. This setting will be memorized and keep unit next operation. Press the same button to turn off the function.

IONIZER OPERATION

Press the "Ionizer Button" (Feature No. 10) on the control panel or (Feature No. 32) on the remote controller once to release the anions. Illuminated light is on the control panel will indicate function is currently in operation. Press the same button to turn the function off.

TIMER OPERATION

- Press the "Timer Button" (Feature No. 9) on the control panel or (Feature No. 30) on the remote controller to set the countdown timer. The unit will operate with its present settings until the timer counts down.
- Timer can be set from 1 to 8 hours.
- Once set, LED display will show the time set.
- To switch off the timer function and operate the unit continuously, press the timer button until LED display switches off and the LED light on the control panel above timer button LED will also be off.

REMOTE CONTROLLER

- Open the remote control battery flap (Feature No. 33) and insert 2 pieces 1.5V "AAA" size of dry battery.
- Remote controller must be aimed at the sensor (Feature No. 16) on the front of the appliance, distance within 5 meters, and will not function from beside or behind the appliance.

CLEANING AND MAINTENANCE (SEE DRAWING 3)

- Ensure the unit is switched off and disconnected from a power source before cleaning.
- Clean outer casing or control panel with a damp cloth only - do not use any abrasive cleaners or harsh chemicals, and ensure the control panel or LED is out of reach of water.
- Check the condition of misting and water tank before every use.
- After long time operation with this appliance, the unit may become clogged with dust and dirt, which will greatly affect the performance of the unit. Sometimes mold and mildew may also occur due to the water tank not regular cleaned, recommend to clean once every two weeks.
- Remove the drain plug (Feature No. 21) and allow the water tank to empty.
- If the unit is being stored for a long period of time without use, empty the water tank before storing or transporting the unit.

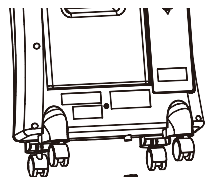

DRAWING 3

CAUTION: PLEASE MAKE SURE THE BATTERY CONTACT (+) & (-) IS CONNECTED TO THE CORRECT POLARITY, OTHERWISE SHORT CIRCUIT & RISK OF FIRE MAY OCCUR DUE TO REVERSE CHARGING.

Warning for the rechargeable lead acid battery

1. This Rechargeable Fan is only applicable for charging the sealed lead-acid battery equipped with this fan. Do not charge other or non-rechargeable batteries.
2. The appliance must be disconnected from power supply before removing the battery.
3. During using or recharging the lead-acid battery, the appliance must be placed in a well-ventilated area.
4. The orientation of the lead-acid battery with regard to polarity battery contact (+) & (-). Do not connect the battery contact (+) & (-) to the correct polarity.
Leaking lead-acid battery must be removed from the appliance carefully. The lead-acid battery must be recycled or disposed of properly.
The lead-acid battery must be removed from the appliance before it is scrapped.

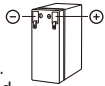

TO REPLACE BATTERY (SEE DRAWING 4)

1. Ensure the unit is switched off and not connected to an AC power outlet.
2. Open the battery compartment cover (Feature No.25) on the back of the unit.
3. Unscrew and remove the mounting plate on top of the battery.
4. Pull out wire connectors of battery terminal and remove from battery compartment.
5. Place the new battery into the battery compartment, attach wire connectors to new battery, Ensure battery is placed correctly in battery compartment according to battery polarity (⊕red area and ⊖black area), install the mounting plate and re-attach screws.
6. Replace the battery compartment cover.

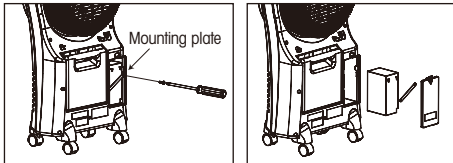

DRAWING 4

ABOUT THE RECHARGEABLE BATTERY

1. Before the first time charging or recharging the battery, ensure all the functions must be in "OFF" position, the main power switch at the rear switched to "OFF"

and plug in the AC power outlet.

2. The Battery Charging indicator (Feature No.8) will become illuminated on the control panel after connection.
3. Battery must be charged for approximately 14-16 hours continuously after use in order to be fully charged.
4. Battery should be charged every month if not in use to maintain its performance.
5. When battery operated under cordless operation, the Power ON/Battery Charging Indicator will not light up.
6. For cordless operation, unplug from the AC power supply, please switch on the main power switch at the rear, press the fan power ON/OFF and select fan speed to start the operation.
7. Do not charge appliance with different types of rechargeable batteries other than the battery type included. Do not fit non-rechargeable batteries.
8. When recharging the battery, ensure the appliance is in a well-ventilated area and switched off all functions and the main power switch at the rear.
9. The efficiency may decrease:
 - a) When the battery is used to the end without recharge.
 - b) When the battery is recharged at temperature below 32°F(0°C) or above 113°F(45°C).

TECHNICAL SPECIFICATIONS

Input Voltage	AC220-240V 50/60Hz
Input Power	65W
Operating Temperature.....	0°C-45°C
Humidity	Lower than 90%
DC Motor	12V
Fan Maximum Air Volume	> 250M ³ /Hour
Fan Maximum Speed.....	4.5m/s
Water Tank Capacity	4 Liter
Max Mist Water Volume:	
AC Operated at Max	Approx 300ml/hr
DC Operated at Max	Approx 150ml/hr
Ion Density.....	Approx 3 x 10 ⁶ ion/cm ³
Timer Control	1-8 Hours
Remote Control Distance.....	Approx 5 Meters
Battery Spec	Rechargeable Lead-acid 12V/7.7Ah
Charging Time of Battery:	Approx 14-16 Hours Continuously

Run Time Of Battery

- ① Fan (High Speed)
- ② Fan (Mid Speed).....
- ③ Fan (Low Speed)
- ④ Fan (High Speed)+Mist (Max)
- ⑤ Fan (Mid speed)+Mist (Max)
- ⑥ Fan (Low Speed)+Mist (Max)
- Dimension
- N. W.

CELLINI Italy

充電式超聲波冷霧電風扇

有線、無線兩用，帶離子空氣淨化功能

產品型號: CMF250R

使用說明書

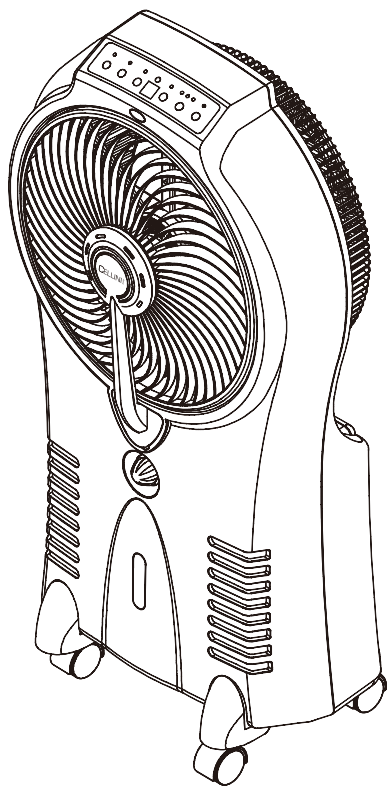

警告：

- (1) 電池必須時常維持充滿電的狀態下。低電量會引起硫酸化，會損壞電池性能並縮短循環使用（放電）時間及壽命，因為自放電最終會使電池完全放電並損壞電池。因此，電池在使用後應立即充電，如果充滿電後長時間未使用，則需每個月充電一次持續14至16小時。
- (2) 為了使電池保持良好狀態，請使用持續14至16小時的完全飽和充電。如果充電週期不允許，則需在2-3週內給電池一次完全飽和的充電。

注意事項：

1. 使用前，請將機身後的主要開/關電源開啟。
2. 使用後，請將機身後的主要開/關電源關閉。

功能及名稱簡介 (圖解)

- | | | |
|-------------|----------------|----------------------|
| 1. 定時顯示燈 | 12. 定時時間及溫度顯示器 | 24. 主電源開/關 |
| 2. 離子顯示燈 | 13. 導風網轉動開關 | 25. 電池箱門 |
| 3. 冷霧顯示燈 | 14. 風速選擇鍵 | 26. 水箱 |
| 4. 導風網轉動顯示燈 | 15. 電源開關 | 27. 電源遙控 |
| 5. 風扇低速顯示燈 | 16. 遙控接收器 | 28. 風向遙控 |
| 6. 風扇中速顯示燈 | 17. 霧化器 | 29. 霧化遙控 |
| 7. 風扇高速顯示燈 | 18. 強弱霧化調節器 | 30. 定時遙控 |
| 8. 電源/充電顯示燈 | 19. 水位指示 | 31. 風速遙控 |
| 9. 定時選擇鍵 | 20. 旋轉滑輪 | 32. 離子遙控 |
| 10. 離子開關 | 21. 排水塞 | 33. 遙控器電池蓋 |
| 11. 冷霧開關 | 22. 導風網 | 34. 蓄電池
(預裝在電池箱內) |

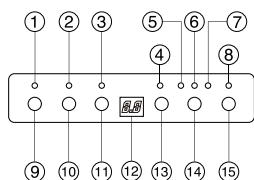

控制面板

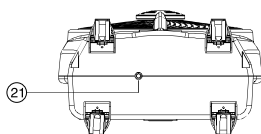

底部

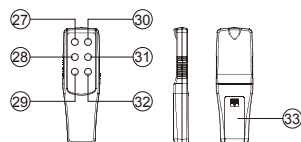

遙控器

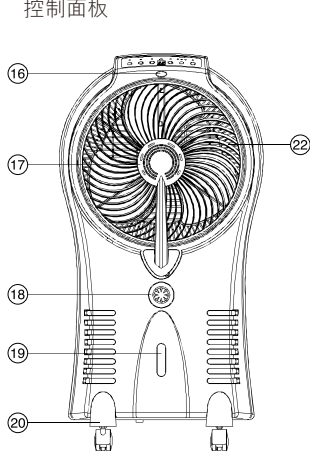

正面

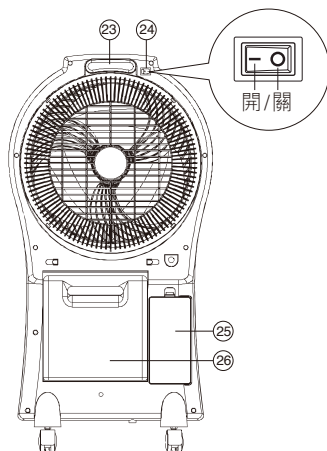

背面

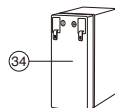

注意：為減少觸電危險，切勿把產品暴露於雨中或潮濕環境中，亦不要拆去後部零件。機身內並無使用者維修的零件，請將維修工作委托給專業資格人員。



三角型內有箭頭的閃電符號旨在提醒使用者，本產品機殼內有未經絕緣的“危險電壓”其幅度足使人觸電而發生危險！



三角型內加感嘆號旨在提醒用戶，有重要的操作與保養說明配合本機，請仔細閱讀後方可使用！

產品特點及適用範圍

1. 新概念風扇，移動方便，外型美觀。
2. 長壽命低噪音電機，節省用電。
3. 兼具送風、淨化空氣、加濕等功能於一體。
4. 旋轉式導風網，加大吹風面積。
5. 有線或無線兩用離子空氣淨化器、除塵、除臭，有效阻擋細菌功能。
6. 超聲波霧化器，提高加濕空氣和降溫功效。
7. 輕觸式按鍵、功能顯示燈及溫度顯示。
8. 適用於家庭使用。

注意事項：

1. 在使用前，必須詳細閱讀此說明書，方可開始接上電源。
2. 本產品的電源性質只能使用220-240V 50/60Hz。
3. 長時間不使用時，插頭電源線應從插座中拔出。
4. 給水箱注水時，應使用的成分純度高、細菌少的水，水箱中的水要經常添加，使其保持在安全水位，更要定期進行更換和清洗水箱。
5. 清潔外殼污垢時，請用蘸有稀釋中性洗滌劑的布輕輕擦去污垢，然後再用乾布仔細擦拭，直至光潔。
6. 如在潮濕環境下不需使用噴霧功能。
7. 當長時間不用本產品時，請清空水箱內的儲水。

安裝滑輪：

1. 打開包裝，取出電風扇，按(圖示一)所示，將滑輪往腳座的中間孔位插下，將組裝好的旋轉滑輪裝入機身底部。
2. 用螺絲刀順時針方向將螺絲旋緊。
3. 如有需要，可鎖定滑輪不讓機器移動。
4. 風扇應放置於疏風暢及較水平的地方，使用時不得傾斜。

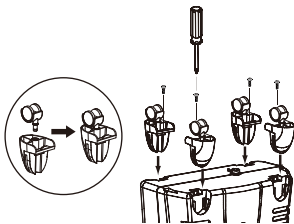

(圖示一)

風扇操作功能

1. 接通交流電220V電源，顯示燈(圖解8)亮，蜂鳴器響一聲，風扇處於待機狀態。
2. 按主機背後電源開關(圖解24)及風扇控制面板的電源開關(圖解15)開啟風扇，初次開啟設定為風扇低速，顯示器(圖解12)顯示當前溫度。
3. 按風速選擇鍵(圖解14)可以選擇風速，風速分高、中、低三檔，同時風速指示燈作相應風速顯示。
本機備有設置記憶功能，會於下次開啟時保持前次設定的風檔。
4. 按導風網轉動開關(圖解13)，風網轉動，導風網轉動顯示燈(圖解4)亮，再按一次停止。本機備有設置記憶功能，會於下次開啟時保持前次導風網設定。

** 無線操作說明請參閱“充電操作”部份。

霧化操作功能

1. 補充水的時候，確保本機置於在平面上，拔除電源線，並關閉所有操作功能。
2. 卸下水箱(圖解26)，注水入水箱，注水不要超過(圖1)的指示線，同時確定水不會溢出。
3. 如水位低於最低要求水平，噴霧功能將會無法有效操作。

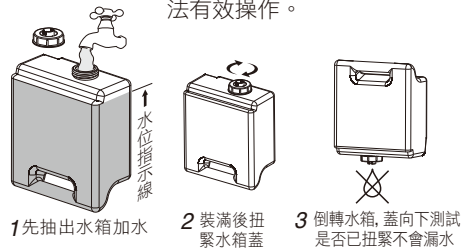

1 先抽出水箱加水

2 裝滿後扭緊水箱蓋

3 倒轉水箱，蓋向下測試是否已扭緊不會漏水

4 將水箱放回機身

充水完畢後，請重新接駁電線，開啟主電源開關及風扇控制面板上的電源開關，再選擇適合風速正式啟動風扇。

4. 按本機控制面板“霧化ON/OFF按鈕”(圖解11)或遙控器上的控制面板(圖解27)，按壓打開或關閉的噴霧功能；面板上的燈亮著時，顯示目前噴霧正在運作。

- 調節噴霧密度，旋轉本機“霧化旋扭制”(圖解18)，順時針旋轉增大噴密度、逆時針方向以降低噴霧密度，可獲得最佳的霧化性能需求。
- 每次運行風扇時重啟噴霧功能，可能要等候一分鐘時間噴霧功能才運作，這是正常的。

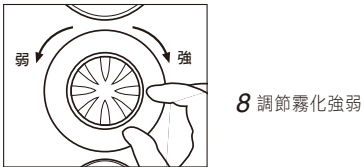
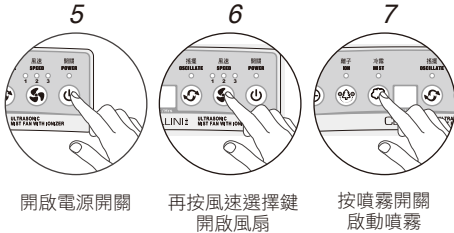

警告：

- 初次啟動時，由於要先排出噴霧喉管內的空氣，噴霧將稍後片刻才能開始運作。
- 注意缺水保護：當水箱缺水時，蜂鳴器發出報警聲響，且噴霧顯示燈閃爍，水泵自動停止工作，加水後重新開啟可恢復操作。
- 切勿將水直接注入風扇機殼內，會造成噴霧不良。(圖解二)

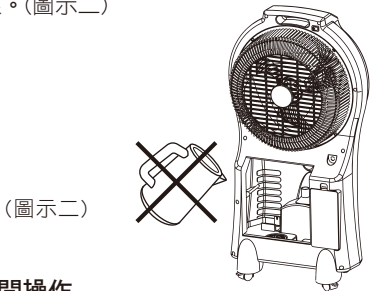

預設時間操作

- 按定時鍵(圖解9)開啟設置定時功能或遙控器(圖解30)，面板上的顯示燈亮起。
- 可任意選擇1-8小時定時設置。
- 定時時間顯示器(圖解12)顯示定時，連續按此鍵，可調整定時時間。
- 持續按下計時器按鈕，直至LED屏幕關閉和控制面板上的定時LED指示燈熄滅才完成。

遙控操作

本機也可通過遙控操作，遙控器按鍵與控制面板相同。

- 打開遙控器背部電池蓋裝上兩粒AAA1.5V乾電池即可使用。
- 使用遙控器時應對準風扇遙控接收器(圖解16)，有效遙控距離為5米。

負離子操作

按本機控制面板“離子產生器按鈕”(圖解10)或遙控器面板功能(圖解32)一次以釋放負離子，顯示燈亮著指示功能正在運行中，如停止使用按下一按鈕來關閉該功能。

保養與清潔(圖解三)

- 請確保機組已關閉並拔掉電源插頭才可進行清洗，以免發生危險。
- 清潔外殼或控制面板時只需用濕布，不要使用任何具有研磨作用的清潔劑或刺激性化學品。
- 每次使用前請檢查噴霧及水箱的狀態。
- 本產品長時間操作後，水箱內部件可能堵塞灰塵和污垢，這將極大影響裝置的性能，建議每兩週清洗一次。
- 如裝置長時間不使用，需存儲此裝置，請先清空水箱內積水。
- 按(圖解三)所示卸下排水塞(圖解21)可釋放內部積水。

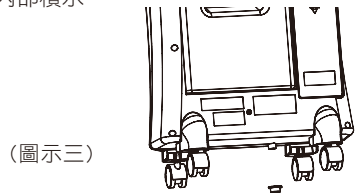

充電操作

接上交流電220V充電時，在未開啟機背後的主開關時，電源顯示燈(圖解8)亮起即進入充電狀態，在充電時所有功能必須關閉及連續充電約14至16小時才使用，若蓄電池電量不充足時，請將風扇關掉才充電，否則會影響充電的進度。

注意事項：

- 風扇運作過程中，當指示燈轉暗或者運作減弱時請重新充電。
- 充電時需關閉主開關及所有功能，否則充電效率會減弱。
- 導致運作效率降低原因：
 - 當充電池用盡後才充電。

b)當蓄電池溫度低於32°F(0°C)或高於113°F(45°C)。

4. 如長時間不使用產品，請每個月持續性充電14至16小時一次，否則會減低電池操作時間和效能。

使用蓄電池

在沒有交流電的情況下，本風扇亦可使用接上蓄電池加長其操作時間，確保充滿電的12V蓄電池的正負極接上本裝置的電池接線端子即可。

注意：●正負電極性不能相反對接，否則不能正常工作！

- 本產品僅對機內電池充電，對非本公司的外購蓄電池並無充電的功能！

當充電完畢及開始使用無線風扇操作時，請拔掉主插頭才開始操作。

在無線操作情況下，控制面板上的電源/充電指示燈(圖解8)不會亮著；請先開啟風扇背部的主電源開關(圖解24)，按一下風扇的電源開關(圖解15)並按下風速選擇鍵設定所需風速便可。

更換蓄電池(圖示四)

1. 確保風扇處於關閉狀態，並且拔掉連接AC交流電源插頭。
2. 在風扇背面拆開電池箱門蓋(圖解25)。
3. 旋開固定板上的螺絲後拉出電池。
4. 首先解除連接電池導線連接端子才取出電池，將新的電池放入電池箱內。
5. 確保電池的正負極是否連接正確，根據電池極性(⊕紅色位置和⊖黑色位置)將導線連接新電池，裝上固定板並旋緊螺絲。
6. 重新蓋上電池箱門蓋。

注意：本機只允許使用充電式蓄電池，切勿使用不同類型或非充電式電池進行充電！

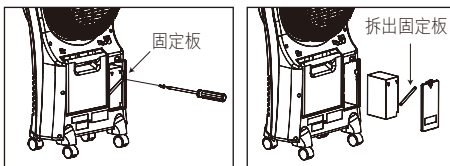

(圖示四)

注意：請確保電池接觸點(+)和(-)連接到正確的極性，如反向充電會引至短路及火災風險發生。

適當使用充電電池

- 更換電池或移動電池時，應將本機的電源關掉！

- 安裝電池時必須注意電池的正負極要與標註相應。

- 發現滲漏電解液及破裂的電池，必須取出機外小心處理，切勿拋置於垃圾箱內，應回收循環再用。

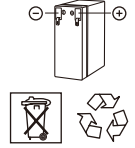

- 正常儲存電池：請將電極用絕緣膠布貼蓋，切勿短路電池的正負極，防止發生危險事故！
- 在棄掉電池前，必須將電池從機身內取出。

警告：

- 如果電源線損壞，為避免危險，切勿繼續使用及聯絡本公司的售後服務部進行維修。
- 本產品不預備給體能弱、反應遲緩或有精神障礙的人(包括兒童)使用，除非在對其負有安全責任的人員的指導或幫助下安全使用；
- 兒童應被監督，以保證他們不玩耍本產品。

主要技術參數：

1. 電源電壓：AC220-240V 50/60Hz
2. 額定輸入功率：65W
3. 使用環境溫度：0°C至45°C；
4. 使用周圍空氣相對濕度：小於90%
5. 風流量：快速 >250M³/Hr
6. 風速：4.5m/s
7. 水箱裝水量：4L
8. 噴霧量(水蒸發量)：
AC啟動約300ML/Hr
DC啟動約150ML/Hr
9. 離子密度：3 × 10⁶ Ion/cm³
10. 定時器設定：1-8小時
11. 遙控器遙控距離：約5米
12. 電池規格：12V/7.7Ah充電池
13. 遙控器電池：(AAA) 1.5V × 2pcs
14. 充電時間：持續性充電14至16小時(停止所有功能操作下)
15. 產品尺寸：約W420 × D252.5 × H819.5毫米
16. 淨重：約8.1公斤

使用時間：

- ①風扇(高速)：約5小時
- ②風扇(中速)：約8小時
- ③風扇(低速)：約13小時
- ④風扇(高速)+噴霧(最大)：約1.5小時
- ⑤風扇(中速)+噴霧(最大)：約2.3小時
- ⑥風扇(低速)+噴霧(最大)：約2.5小時